

EFFECTIVE:
29-MAR-18

DIMENSION PRINT

TOTALLY ENCLOSED FAN COOLED

PRINT:
07-2044-70

SUPERSEDES:
24-JUL-15

FRAME: 449
BASIC TYPE: J

SHEET:
1 OF 1

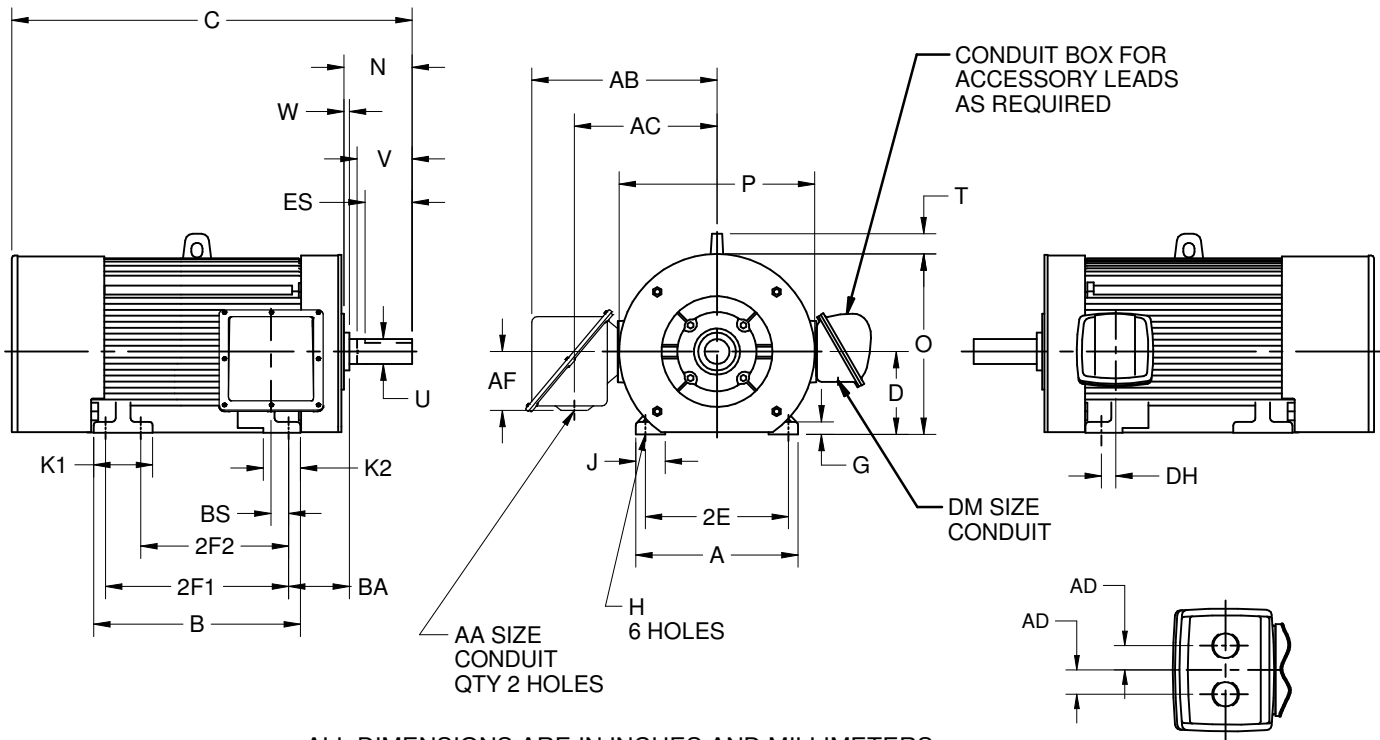

ALL DIMENSIONS ARE IN INCHES AND MILLIMETERS

UNITS	A	B	D	2E	2F1	2F2	G	H	J	K1	K2	O	P ²
IN	22.00	28.00	11.00	±.03	±.03	±.03	1.50	.81	4.00	8.00	5.00	24.06	26.50
MM	559	711	279	457	635	508	38	21	102	203	127	611	673

UNITS	T	W	AB	AC	AD	AF	BA	BS	DH
IN	2.88	.44	27.28	21.66	3.00	10.94	7.50	2.50	2.50
MM	73	11	693	550	76	278	191	64	64

FRAME	UNITS	C	N	U	V	ES	SQ	CONDUIT	
								AA	DM
449T	IN	55.13	8.94	3.375	8.25	7.00	.875	2 NPT	3/4 NPT
	MM	1400	227	85.73	210	178	22.23	2 1/2 NPT	1 NPT
449TL	IN	57.13	10.63	4.375	10.25	8.50	1.000	3 NPT	1 1/4 NPT
	MM	1451	270	111.13	260	216	25.40	3 1/2 NPT	1 1/2 NPT
449TM	IN	51.38	5.19	2.875	4.50	3.63	.750	4 NPT	
	MM	1305	132	73.03	114	92	19.05		
449TS	IN	51.38	5.19	2.375	4.50	3.13	.625		
	MM	1305	132	60.33	114	80	15.88		

1. ALL ROUGH CASTING DIMENSIONS MAY VARY BY .25" DUE TO CASTING AND OR FABRICATION VARIATIONS.
2. LARGEST MOTOR WIDTH.
3. STANDARD ASSEMBLY POSITION F-1 IS SHOWN. F-2 IS PROVIDED WHEN SPECIFIED.
CONDUIT OPENINGS MAY BE LOCATED IN STEPS OF 90 DEGREES REGARDLESS OF LOCATION. STANDARD AS SHOWN WITH CONDUIT OPENING DOWN.

07-2044/G

Nidec Motor Corporation
St. Louis, Missouri

INFORMATION DISCLOSED ON THIS DOCUMENT
IS CONSIDERED PROPRIETARY AND SHALL NOT BE
REPRODUCED OR DISCLOSED WITHOUT WRITTEN
CONSENT OF NIDEC MOTOR CORPORATION



ISSUED BY	R. KING
APPROVED BY	B. GRAY

IHP_DP_NMCA (MAR-2011) SOLIDEDGE