

EFFECTIVE:  
**04-MAY-12**

SUPERSEDES:  
**14-OCT-99**

**HORIZONTAL MOTORS**  
TITAN LINE, WP-TYPE II  
FRAME: 6800MS  
BASIC TYPE: H

PRINT:  
**07-2153**

SHEET:  
**1 OF 1**

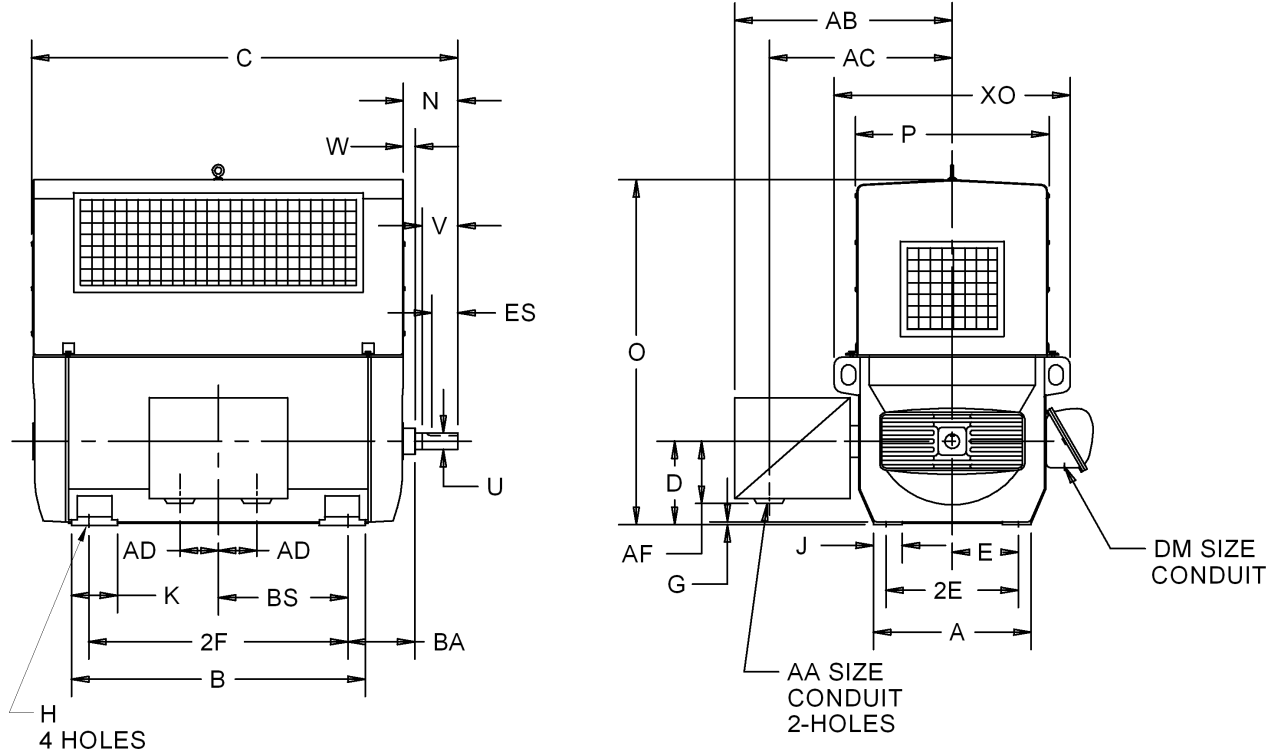

ALL DIMENSIONS ARE IN INCHES AND MILLIMETERS

UNITS	XO	A	G	J	K	N	U <sup>3</sup>	V MIN	W	ES MIN	SQ KEY
IN	47.00	32.00	1.50	6.00	9.00	8.25	-.001	4.375	7.25	5.63	1.00
MM	1194	813	38	152	229	210	111.13	184	13	143	25.40

UNITS	D -.06	E	2E	H	O	P <sup>2</sup>	AA	AB	AC	AD	AF	BA	DM
IN	17.00	13.50	27.00	1.38	70.88	39.00	3 1/2 NPT	36.00	27.38	3.00	10.94	11.50	3/4 NPT
MM	432	343	686	35	1800	991	3 1/2 NPT	914	695	76	278	292	3/4 NPT

FRAME	UNITS	B	C	2F	BS
6809MS	IN	43.63	70.38	40.00	20.00
	MM	1108	1788	1016	508
6810MS	IN	48.63	75.38	45.00	22.50
	MM	1235	1915	1143	572
6811MS	IN	53.63	80.38	50.00	25.00
	MM	1362	2042	1270	635

1: ALL ROUGH DIMENSIONS MAY VARY BY .25"  
DUE TO CASTING AND/OR FABRICATION VARIATIONS.  
2: LARGEST MOTOR WIDTH.  
3: TOLERANCE UNITS ARE IN INCHES ONLY.

4: STANDARD ASSEMBLY POSITION F-1 IS SHOWN.  
F-2 IS PROVIDED WHEN SPECIFIED. CONDUIT OPENINGS  
MAY BE LOCATED IN STEPS OF 90° REGARDLESS OF LOCATION.  
STANDARD AS SHOWN WITH CONDUIT OPENING DOWN.

07-2153/A

**Nidec Motor Corporation**  
St. Louis, Missouri

INFORMATION DISCLOSED ON THIS DOCUMENT  
IS CONSIDERED PROPRIETARY AND SHALL NOT BE  
REPRODUCED OR DISCLOSED WITHOUT WRITTEN  
CONSENT OF NIDEC MOTOR CORPORATION



ISSUED BY  
**R. KING**  
APPROVED BY  
**K. POTTER**

IHP\_DP\_NMCA (MAR-2011) SOLIDEDGE