

EFFECTIVE:
27-MAR-12

HORIZONTAL MOTORS

PRINT:
07-2235

SUPERSEDES:
21-DEC-11

FRAME: 360JP
BASIC TYPE: FCT-1, CT-1, CTE-1, CTI-1

SHEET:
1 OF 1

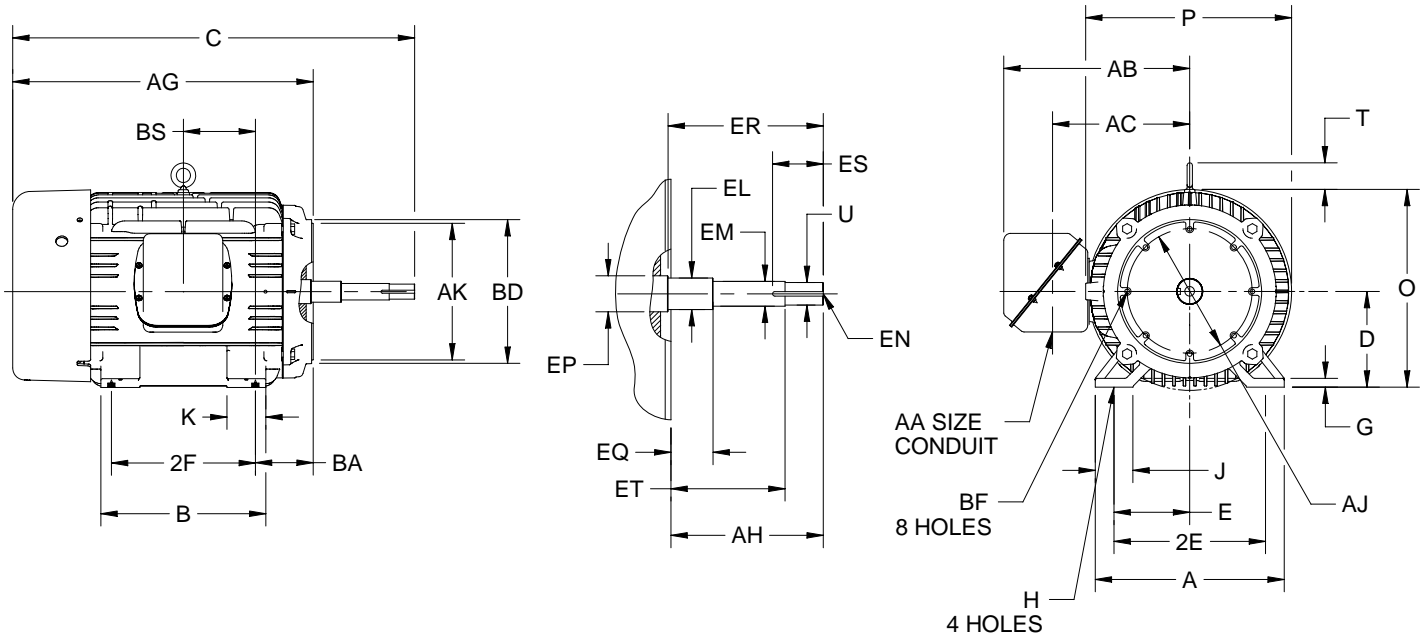

ALL DIMENSIONS ARE IN INCHES AND MILLIMETERS

UNITS	A	B	C	D -.06	E	2E ±.03	G	H +.05	J	K	O	P ²
IN	17.13	14.50	35.06	9.00	7.00	14.00	.81	.66	3.25	3.25	18.13	18.69
MM	435	368	891	229	178	356	21	17	83	83	461	475

UNITS	T	U -.0005	AA	AB	AC	AF	AG	AH ±.030	AJ	AK -.005	BA ±.09	BB MIN
IN	2.50	1.6245	3 NPT	16.81	12.50	3.38	26.94	8.125	11.000	12.500	5.88	0.25
MM	64	41.262		427	318	86	684	206.38	279.40	317.50	149	6

UNITS	BD MAX	BF ⁵	BS	EL -.002	EM -.0005	EP MIN	EQ ±.020	ER MIN	ES MIN	ET ±.020	EN ⁵	SQ KEY
IN	14.00	5/8-11 x .94	6.13	2.125	1.7500	2.50	2.375	8.13	2.53	5.875	1/2-13 x 1.00	.375
MM	356		156	53.98	44.450	64	60.32	206	64	149.23		9.53

FRAME	UNITS	2F ±.03
364JP	IN	11.25
	MM	286
365JP	IN	12.25
	MM	311

TOLERANCES	
FACE RUNOUT	.007 T.I.R.
PERMISSIBLE ECCENTRICITY OF MOUNTING RABBET	.007 T.I.R.
PERMISSIBLE SHAFT RUNOUT	.003 T.I.R.

1. ALL ROUGH CASTING DIMENSIONS MAY VARY BY .25" DUE TO CASTING AND/OR FABRICATION VARIATIONS.
2. LARGEST MOTOR WIDTH.
3. TOLERANCES SHOWN ARE IN INCHES ONLY.

4. CONDUIT BOX MAY BE LOCATED ON EITHER SIDE OF MOTOR. CONDUIT OPENINGS MAY BE LOCATED IN STEPS OF 90 DEGREES REGARDLESS OF LOCATION. STANDARD AS SHOWN WITH CONDUIT OPENING DOWN.
5. TAP SIZE AND BOLT PENETRATION ALLOWANCE.

07-2235/B

Nidec Motor Corporation
St. Louis, Missouri

INFORMATION DISCLOSED ON THIS DOCUMENT IS CONSIDERED PROPRIETARY AND SHALL NOT BE REPRODUCED OR DISCLOSED WITHOUT WRITTEN CONSENT OF NIDEC MOTOR CORPORATION



ISSUED BY
R. KING
APPROVED BY
J. HAGENE

IHP_DP_NMCA (MAR-2011) SOLIDEDGE