

EFFECTIVE:
15-MAR-11

HORIZONTAL MOTORS

PRINT:
07-2284

SUPERSEDES:
25-JUN-01

FRAME: 360TSD
TYPE: FTC, TCE, CE

SHEET:
1 OF 1

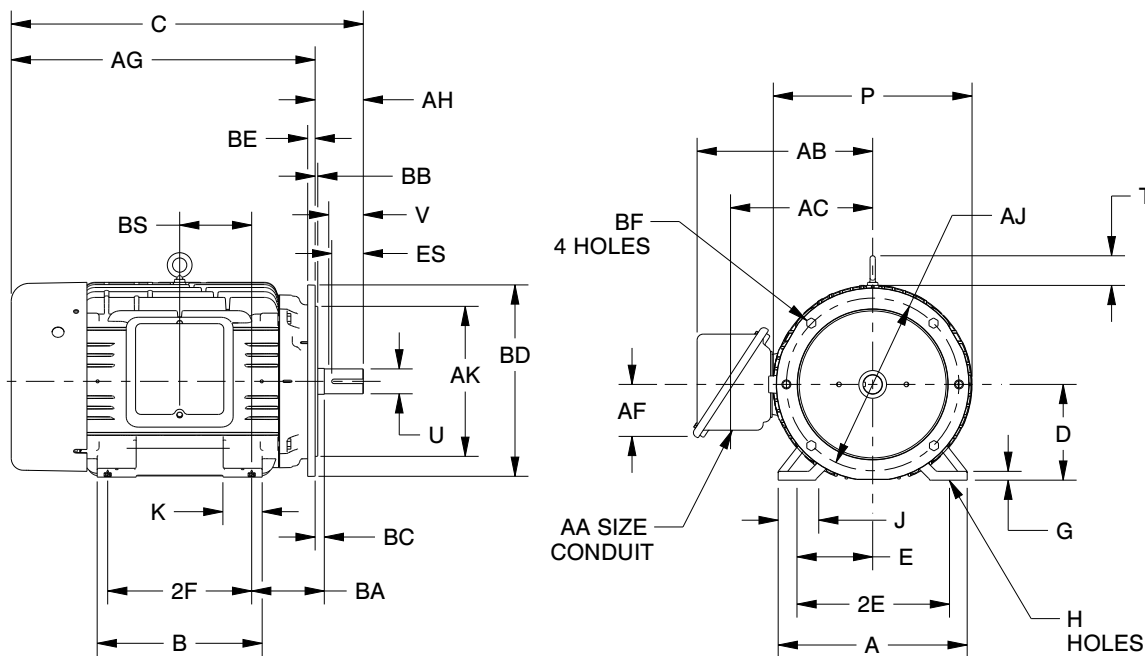

	A	B	C	D -.06	E	2E ±.03	G	H +.05
IN	17.13	14.50	30.63	9.00	7.00	14.00	.81	.66
MM	435	368	778	229	178	355	21	17

	J	K	O	p ²	T	U -.001	V MIN	AA
IN	3.25	3.25	18.13	18.69	2.50	1.875	3.50	3 NPT
MM	83	83	460	475	64	47.63	89	

	AB	AC	AF	AG	AH	AJ	AK -.005	BA
IN	17.75	13.19	4.88	26.88	3.75	16.000	14.000	5.88
MM	451	335	124	683	95	406.40	355.60	133

	BB MIN	BC	BD MAX	BE	BF	BS	ES MIN	SQ KEY
IN	.19	.00	18.00	.75	.81	6.13	2.03	.500
MM	5	0	457	19	21	156	52	12.70

	FRAME	2F ±.03
IN	364TSD	11.25
MM		288
IN	365TSD	12.25
MM		311

TOLERANCES	INCHES
FACE RUNOUT	.007 FIR
PERMISSIBLE ECCENTRICITY OF MOUNTING RABBET	.007 FIR
PERMISSIBLE SHAFT RUNOUT	.003 FIR

1: ALL ROUGH CASTING DIMENSIONS MAY VARY .25" DUE TO CASTING VARIATIONS.
2: LARGEST MOTOR WIDTH
3: TOLERANCES ARE SHOWN IN INCHES ONLY.

4: CONDUIT BOX MAY BE LOCATED ON EITHER SIDE OF MOTOR. CONDUIT OPENINGS MAY BE LOCATED IN STEPS OF 90 DEGREES REGARDLESS OF LOCATION. STANDARD AS SHOWN WITH CONDUIT OPENING DOWN.

07-2284/A

Nidec Motor Corporation
St. Louis, Missouri

INFORMATION DISCLOSED ON THIS DOCUMENT IS CONSIDERED PROPRIETARY AND SHALL NOT BE REPRODUCED OR DISCLOSED WITHOUT WRITTEN CONSENT OF NIDEC MOTOR CORPORATION



ISSUED BY
K. FRIEDMAN
APPROVED BY
K. POTTER

IHP_DP_NMCA (MAR-2011) PROENGINEER