

EFFECTIVE:
28-MAR-11

HORIZONTAL MOTORS

PRINT:
07-2286

SUPERSEDES:
24-JAN-05

TEFC
FRAME: 140TC
BASIC TYPE: UT

SHEET:
1 OF 1

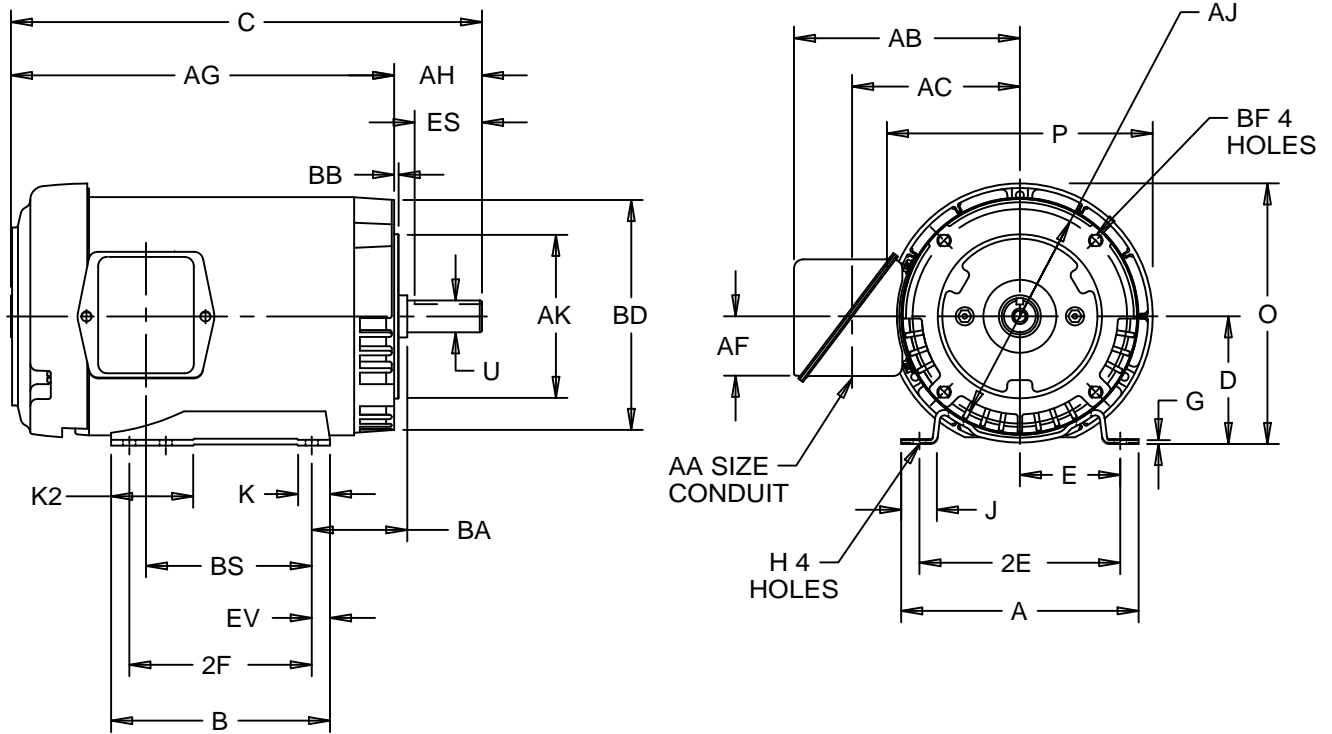

ALL DIMENSIONS ARE IN INCHES AND MILLIMETERS

UNITS	A	B	C	D -.06	E	2E ±.03	G	H +.05	J	K	K2	O	P ²
IN	6.50	6.00	13.13	3.50	2.75	5.50	.13	.34	.88	.88	1.88	7.16	7.28
MM	165	152	334	89	70	140	3	9	22	22	48	182	185

UNITS	U -.0005	AA	AB	AC	AF	AG	AH	AJ	AK -.003
IN	.8750	.75	6.09	4.50	1.59	11.00	2.13	5.875	4.500
MM	22.225		155	114	40	279	54	149.23	114.30

UNITS	BA	BB MIN	BD MAX	BF-4 ³	BS	ES MIN	EV	SQ KEY
IN	2.75	.13	6.50	3/8-16 x .75	4.78	1.53	.50	.188
MM	70	3	165		121	39	13	4.78

FRAME	UNITS	2F ±.03
143TC	IN	4.00
	MM	102
145TC	IN	5.00
	MM	127

1: ALL ROUGH CASTING DIMENSIONS MAY VARY BY .25" DUE TO CASTING AND/OR FABRICATION VARIATIONS.
2: LARGEST MOTOR WIDTH.
3: TAP SIZE AND BOLT PENETRATION ALLOWANCE.
4: ALL TAP HOLES ARE UNIFIED NATIONAL COARSE, RIGHT HAND THREAD.

5: CONDUIT BOX MAY BE LOCATED ON EITHER SIDE OF MOTOR. CONDUIT OPENINGS MAY BE LOCATED IN STEPS OF 90 DEGREES REGARDLESS OF LOCATION. STANDARD AS SHOWN WITH CONDUIT OPENING DOWN.
6: TOLERANCES SHOWN ARE IN INCHES ONLY.
7: FRAME REFERENCE: 7.75/143/145

07-2286/D

Nidec Motor Corporation
St. Louis, Missouri

INFORMATION DISCLOSED ON THIS DOCUMENT IS CONSIDERED PROPRIETARY AND SHALL NOT BE REPRODUCED OR DISCLOSED WITHOUT WRITTEN CONSENT OF NIDEC MOTOR CORPORATION



ISSUED BY
L. CUESTA
APPROVED BY
E. LIZANA

IHP_DP_NMCA (MAR-2011) SOLIDEDGE