

EFFECTIVE:
16-MAY-11

HORIZONTAL MOTORS

TENV, STAINLESS STEEL FRAME, FOOTED

PRINT:
07-2484

SUPERSEDES:
14-NOV-02

FRAME: 56HC
BASIC TYPE: SSN

SHEET:
1 OF 1

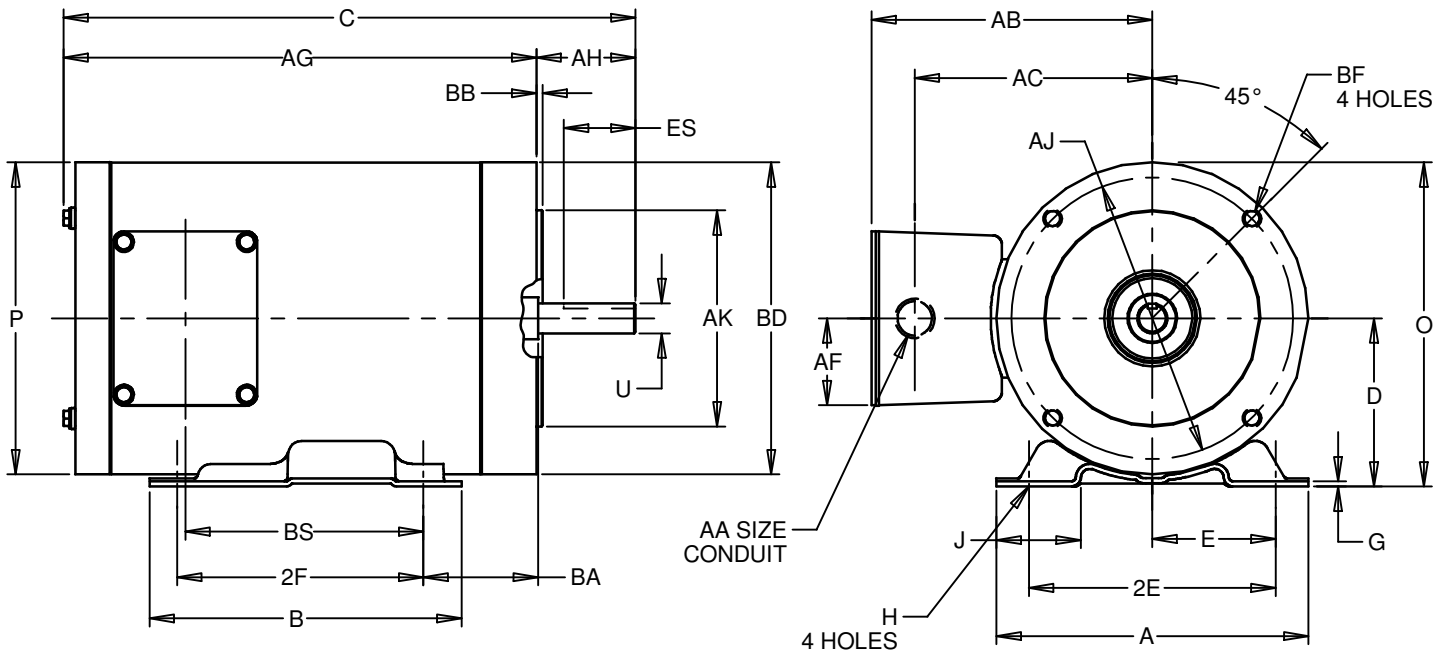

ALL DIMENSIONS ARE IN INCHES AND MILLIMETERS

UNITS	A	B	C	D	E	2E	2F	G	H	J	O	P ²	U
IN	6.50	6.50	11.94	3.50	2.75	5.50	5.00	.13	.34	1.75	6.75	6.50	.6250
mm	165	165	303	89	70	140	127	3	9	44	171	165	15.875

UNITS	AA	AB	AC	AF	AG	AH	AJ	AK
IN	1/2 NPT	6.00	4.94	1.81	9.88	2.06	5.875	4.500
mm		152	126	46	251	52	149.23	114.30

UNITS	BA	BB	BD	BF ³	BS	ES	SQ
IN	2.75	.13	6.500	3/8-16 X .75	4.75	1.41	.188
mm	70	3	165.10		121	36	4.78

TOLERANCES	
FACE RUNOUT	.004 T.I.R
PERMISSIBLE ECCENTRICITY OF MOUNTING RABBET	.004 T.I.R
PERMISSIBLE SHAFT RUNOUT	.002 T.I.R

- 1: ALL ROUGH DIMENSIONS MAY VARY .25" DUE TO CASTING AND/OR FABRICATION VARIATIONS
- 2: LARGEST MOTOR WIDTH
- 3: TAP SIZE AND BOLT PENETRATION ALLOWANCE
- 4: ALL TAPPED HOLES ARE UNIFIED NATIONAL COARSE, RIGHT HAND THREAD
- 5: TOLERANCES ARE ALL IN INCHES
- 6: FRAME REFERENCE: 7.750/56/143/145

07-2484/A

Nidec Motor Corporation
St. Louis, Missouri

INFORMATION DISCLOSED ON THIS DOCUMENT IS CONSIDERED PROPRIETARY AND SHALL NOT BE REPRODUCED OR DISCLOSED WITHOUT WRITTEN CONSENT OF NIDEC MOTOR CORPORATION



ISSUED BY
A. HINGANKAR
APPROVED BY
R. KING

IHP_DP_NMCA (MAR-2011) SOLIDEDGE