

EFFECTIVE:  
**25-MAY-11**

SUPERSEDES:  
**25-FEB-03**

**HORIZONTAL MOTORS**  
ODP - WITH "C" BRACKET  
FRAME: 213-215TC  
BASIC TYPE: DM

PRINT:  
**07-2569**

SHEET:  
**1 OF 1**

STANDARD F-1 ASSEMBLY

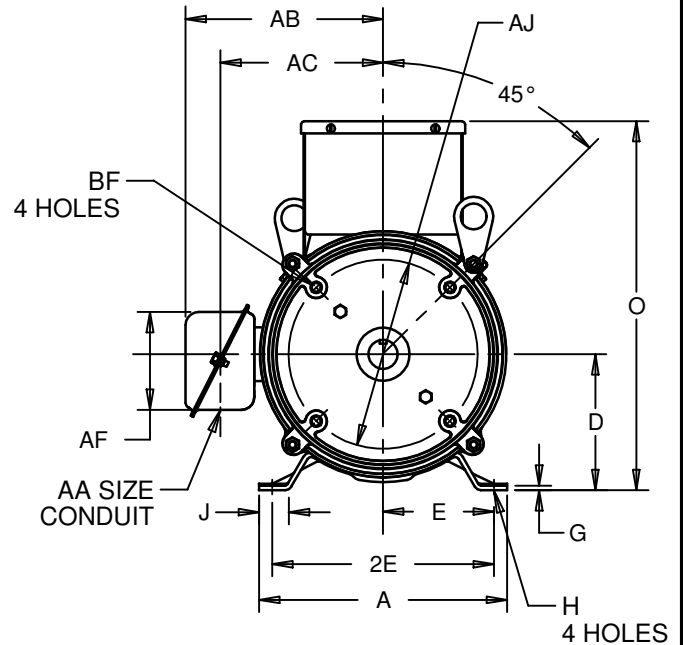
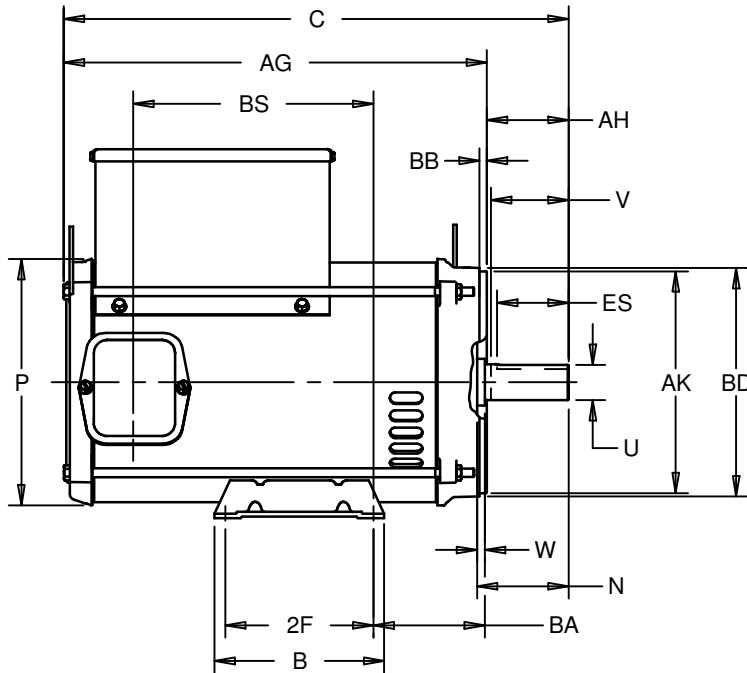

ALL DIMENSIONS ARE IN INCHES AND MILLIMETERS

BASIC SIZE	UNITS	A	D -.06	E	2E ±.03	G	H +.05	J	N	O	P <sup>2</sup>	U -.001
210	IN	9.50	5.25	4.25	8.50	.19	.41	1.13	3.63	14.16	9.44	1.375
	MM	241	133	109	216	5	10	29	92	360	240	34.93

BASIC SIZE	UNITS	V MIN	W	AA	AB	AC	AF	AH ±.031	AJ	AK -.003	BA	BB ±.031
210	IN	3.00	.50	1.00	7.59	6.38	2.13	3.125	7.250	8.500	4.25	.281
	MM	76	13		193	162	54	79.38	184.15	215.90	108	7.14

BASIC SIZE	UNITS	BD MAX	BF <sup>3</sup>	ES MIN	SQ KEY
210	IN	9.00	1/2-13 X .75	2.53	.313
	MM	229		64	7.95

SIZE	UNITS	B	C	2F ±.03	AG	BS
213	IN	6.50	19.35	5.50	16.22	9.06
	MM	165	491	140	412	230
215	IN	8.00	20.85	7.00	17.72	10.56
	MM	203	530	178	450	268

- 1: ALL ROUGH DIMENSIONS MAY VARY BY .25" DUE TO CASTING AND/OR FABRICATION VARIATIONS.
- 2: LARGEST MOTOR WIDTH.
- 3: TAP SIZE AND BOLT PENETRATION ALLOWANCE.
- 4: ALL TAPPED HOLES ARE UNIFIED NATIONAL COARSE, RIGHT HAND THREAD.
- 5: CONDUIT BOX MAY BE LOCATED ON EITHER SIDE AND CONDUIT OPENING MAY BE LOCATED IN STEPS OF 90° REGARDLESS OF LOCATION. STANDARD AS SHOWN WITH CONDUIT OPENING DOWN.
- 6: TOLERANCES SHOWN ARE IN INCHES ONLY.
- 7: FRAME REFERENCE: 213/13.500 215/15.000

TOLERANCES	
FACE RUNOUT	.004 T.I.R.
PERMISSIBLE ECCENTRICITY OF MOUNTING RABBET	.004 T.I.R.
PERMISSIBLE SHAFT RUNOUT	.002 T.I.R.

07-2569/A

**Nidec Motor Corporation**  
St. Louis, Missouri

INFORMATION DISCLOSED ON THIS DOCUMENT IS CONSIDERED PROPRIETARY AND SHALL NOT BE REPRODUCED OR DISCLOSED WITHOUT WRITTEN CONSENT OF NIDEC MOTOR CORPORATION



ISSUED BY  
**A. HINGANKAR**  
APPROVED BY  
**R. KING**

IHP\_DP\_NMCA (MAR-2011) SOLIDEDGE