

EFFECTIVE:
21-NOV-13

SUPERSEDES:
26-MAY-11

DIMENSION PRINT

WITH "C" BRACKET AND STEARNS BRAKE

FRAME: 140TC
BASIC TYPE: UTF

PRINT:
07-2668

SHEET:
1 OF 1

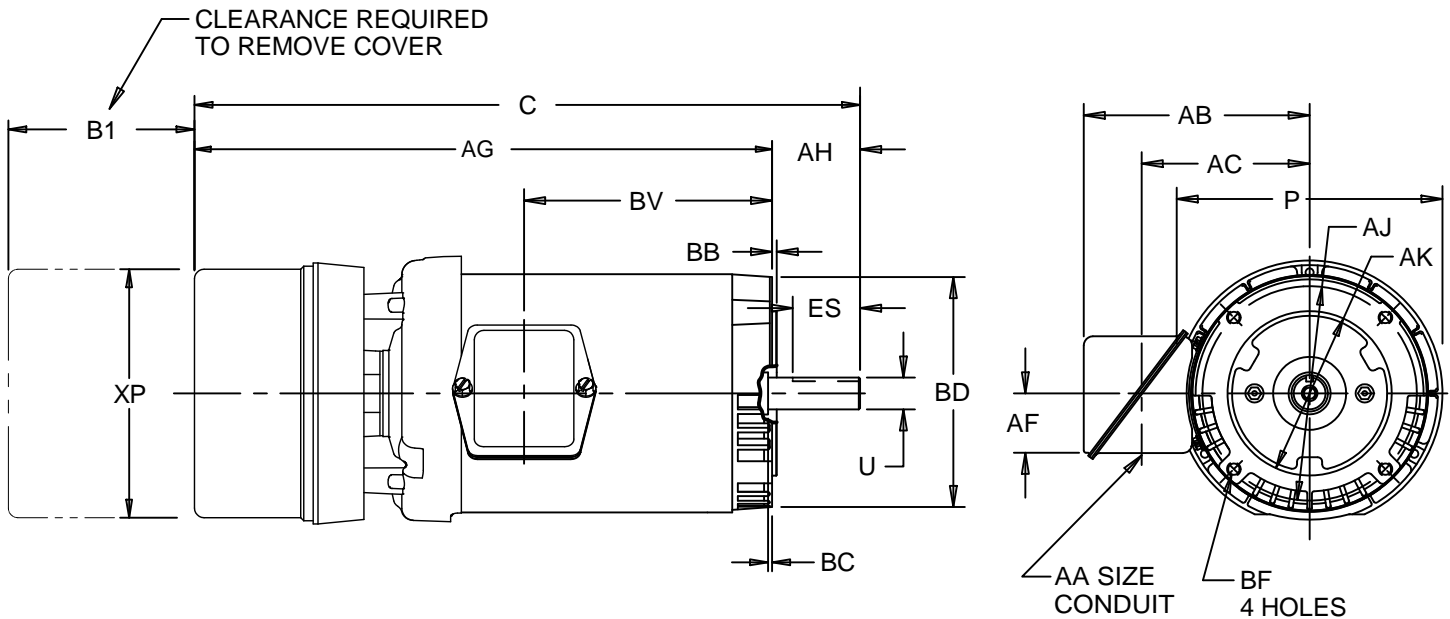

ALL DIMENSIONS ARE IN INCHES AND MILLIMETERS

UNITS	C	P ²	U -.0005	AA	AB	AC	AF	AG	AH	AJ	AK -.003	BB -.06
IN	18.09	7.31	.8750	.75	6.09	4.50	1.59	15.84	2.13	5.875	4.500	.16
MM	459	186	22.225		155	114	40	402	54	149.23	114.30	4

UNITS	BC	BD MAX	BV	BF ³	B1	ES MIN	SQ KEY	XP
IN	.13	6.50	7.38	3/8-16 X .75	2.94	1.41	.188	6.54
MM	3	165	187		75	36	4.78	166

NOTE:
THIS PRINT IS GOOD FOR MOTORS WITH STEARNS BRAKE 56,3XX SERIES, (NEMA 1, IP21) ENCLOSURE RANGING FROM 1.5 THRU 15 LB. FT.

- 1: ALL ROUGH DIMENSIONS MAY VARY BY .25" DUE TO CASTING AND/OR FABRICATION VARIATIONS.
- 2: LARGEST MOTOR WIDTH.
- 3: TAP SIZE AND BOLT PENETRATION ALLOWANCE.
- 4: ALL TAPPED HOLES ARE UNIFIED NATIONAL COARSE, RIGHT HAND THREAD.

- 5: CONDUIT BOX MAY BE LOCATED ON EITHER SIDE OF MOTOR. CONDUIT OPENINGS MAY BE LOCATED IN STEPS OF 180° REGARDLESS OF LOCATION. STANDARD AS SHOWN WITH CONDUIT OPENING DOWN.
- 6: TOLERANCES SHOWN ARE IN INCHES ONLY.
- 7: FRAME REFERENCE: 6.750/143/145

07-2668/B

Nidec Motor Corporation
St. Louis, Missouri

INFORMATION DISCLOSED ON THIS DOCUMENT IS CONSIDERED PROPRIETARY AND SHALL NOT BE REPRODUCED OR DISCLOSED WITHOUT WRITTEN CONSENT OF NIDEC MOTOR CORPORATION



ISSUED BY R. KING
APPROVED BY J. O'BRIEN

IHP_DP_NMCA (MAR-2011) SOLIDEDGE