

EFFECTIVE:
27-MAY-11

SUPERSEDES:
10-OCT-08

HORIZONTAL MOTORS
VECTOR CONTROL
FRAME: 400T
BASIC TYPE: CTBI,CTBX-CONVERSION

PRINT:
07-2697

SHEET:
1 OF 1

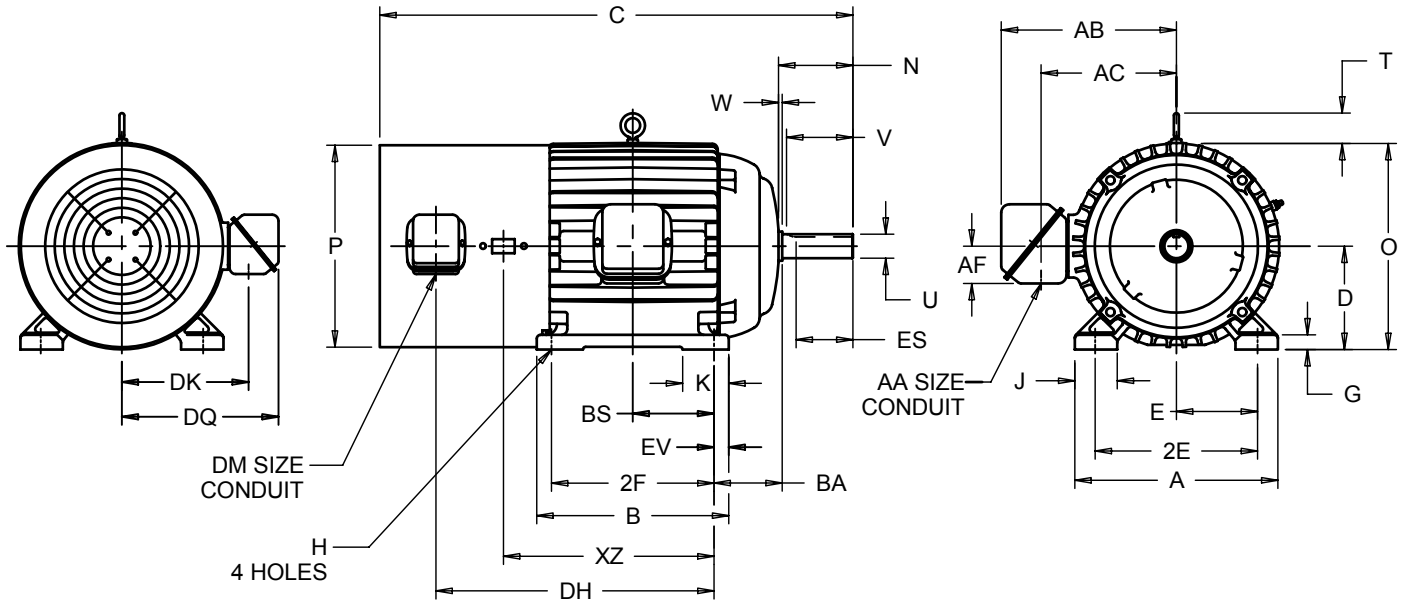

ALL DIMENSIONS ARE IN INCHES AND MILLIMETERS

UNITS	A	B	C	D -.06	E	2E ±.03	G	H +.05	J	K	N
IN	19.75	16.75	44.19	10.00	8.00	16.00	1.38	.81	3.75	5.00	7.63
MM	502	425	1122	254	203	406	35	21	95	127	194

UNITS	O	P ²	T	U -.001	V MIN	W	AA	AB	AC	AF	BA
IN	20.50	21.50	2.94	2.875	7.00	.38	3.00	17.69	13.44	3.38	6.62
MM	521	546	75	73.03	178	10		449	341	86	168

UNITS	BS	DH	DK	DM	DQ	ES MIN	EV	XZ	SQ KEY
IN	6.88	27.50	11.50	.75	13.03	5.6	1.50	22.75	.750
MM	175	699	292		331	142	38	578	19.05

FRAME	UNITS	2F ±.03
404T	IN	12.25
	MM	311
405T	IN	13.75
	MM	349

- 1: ALL ROUGH DIMENSIONS MAY VARY .25" DUE TO CASTING AND/OR FABRICATION VARIATIONS.
- 2: LARGEST MOTOR WIDTH.
- 3: TOLERANCES SHOWN ARE IN INCHES ONLY.
- 4: STANDARD ASSEMBLY POSITION F-1 IS SHOWN F-2 IS PROVIDED WHEN SPECIFIED. CONDUIT OPENINGS MAY BE LOCATED IN STEPS OF 90° REGARDLESS OF LOCATION.
STANDARD AS SHOWN WITH CONDUIT OPENING DOWN

07-2697/A

Nidec Motor Corporation
St. Louis, Missouri

INFORMATION DISCLOSED ON THIS DOCUMENT IS CONSIDERED PROPRIETARY AND SHALL NOT BE REPRODUCED OR DISCLOSED WITHOUT WRITTEN CONSENT OF NIDEC MOTOR CORPORATION



ISSUED BY
M. CHAUDHARI
APPROVED BY
R. KING

IHP_DP_NMCA (MAR-2011) SOLIDEDGE