

EFFECTIVE:
01-JUN-11

SUPERSEDES:
10-AUG-08

HORIZONTAL MOTORS
AUTOMOTIVE DUTY WITH NEMA "C" BRACKET
FRAME: 400UC, 400USC
BASIC TYPE: JAD, JDE

PRINT:
07-2707

SHEET:
1 OF 1

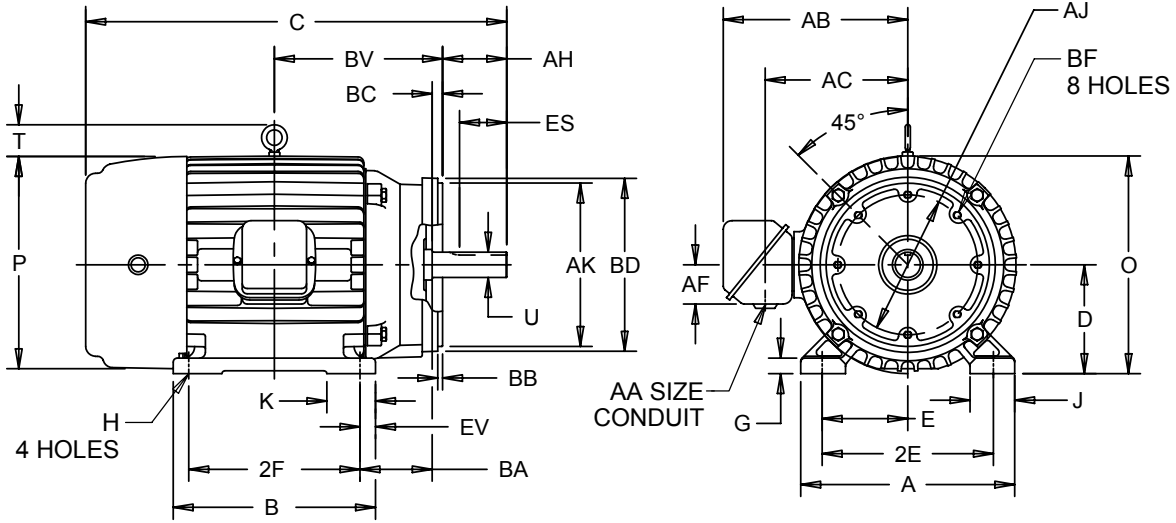

ALL DIMENSIONS ARE IN INCHES AND MILLIMETERS

UNITS	A	B	D -.06	E	2E ±.03	G	H +.05	J	K	O	P ⁵
IN	19.75	16.75	10.00	8.00	16.00	1.38	.81	3.75	5.00	20.50	20.88
MM	502	425	254	203	406	35	21	95	127	521	530

UNITS	T	AA	AB	AC	AF	AJ	AK -.005	BA	BB MIN	BC	BD MAX
IN	2.94	2 1/2 NPT	17.59	13.44	4.19	11.000	12.500	6.63	.25	.25	14.00
MM	75		447	341	106	279.40	317.50	168	6	6	356

UNITS	BF ²	BV	EV
IN	5/8-11X .94	13.75	1.50
MM		349	38

FRAME	UNITS	C	U -.001	AH	ES MIN	SQ KEY
400UC	IN	38.13	2.375	6.88	5.69	.625
	MM	969	60.33	175	145	15.88
400USC	IN	35.25	2.125	4.00	2.88	.500
	MM	895	53.98	102	73	12.70

FRAME	UNITS	2F ±.03
404UC, USC	IN	12.25
	MM	311
405UC, USC	IN	13.75
	MM	349

- 1: ALL ROUGH DIMENSIONS MAY VARY BY .25" DUE TO CASTING AND/OR FABRICATION VARIATIONS.
- 2: TAP SIZE AND BOLT PENETRATION ALLOWANCE.
- 3: ALL TAPPED HOLES ARE UNIFIED NATIONAL COARSE, RIGHT HAND THREAD.
- 4: CONDUIT BOX MAY BE LOCATED ON EITHER SIDE OF MOTOR. CONDUIT OPENINGS MAY BE LOCATED IN STEPS OF 90° REGARDLESS OF LOCATION. STANDARD AS SHOWN WITH CONDUIT OPENING DOWN.
- 5: LARGEST MOTOR WIDTH.
- 6: TOLERANCES SHOWN ARE IN INCHES ONLY.

TOLERANCES	
FACE RUNOUT	.007 T.I.R.
PERMISSIBLE ECCENTRICITY OF MOUNTING RABBET	.007 T.I.R.
PERMISSIBLE SHAFT RUNOUT	.003 T.I.R.

07-2707/A

Nidec Motor Corporation
St. Louis, Missouri

INFORMATION DISCLOSED ON THIS DOCUMENT IS CONSIDERED PROPRIETARY AND SHALL NOT BE REPRODUCED OR DISCLOSED WITHOUT WRITTEN CONSENT OF NIDEC MOTOR CORPORATION



ISSUED BY
P. INGALE
APPROVED BY
R. KING

IHP_DP_NMCA (MAR-2011) SOLIDEDGE