

EFFECTIVE:  
**09-JUN-11**

SUPERSEDES:  
**08-MAR-10**

# HORIZONTAL MOTORS

## AUTOMOTIVE DUTY WITH NEMA "C" BRACKET

FRAME: 444, 445, 447UC, USC  
BASIC TYPE: JAD, JDE

PRINT:  
**07-2766**

SHEET:  
**1 OF 1**

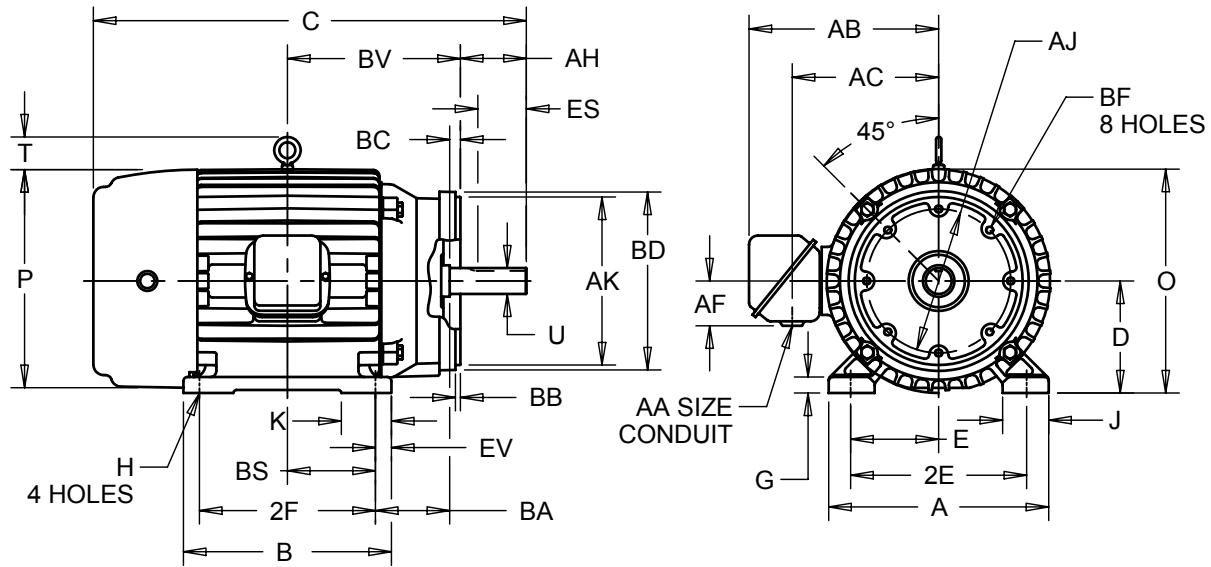

ALL DIMENSIONS ARE IN INCHES AND MILLIMETERS

UNITS	A	D -.06	E	2E ±.03	G	H +.05	J	O	P <sup>5</sup>	T	AA	AB
IN	22.00	11.00	9.00	18.00	1.50	.81	4.00	22.63	23.50	3.25	2 ½ NPT	19.75
MM	559	279	229	457	38	21	102	575	597	83		502

UNITS	AC	AF	AJ	AK -.005	BA ±.09	BB	BC	BD MAX	BF <sup>2</sup>	EV
IN	15.13	5.53	14.000	16.000	7.50	.25	.25	18.00	5/8-11 X .94	1.50
MM	384	140	355.60	406.40	191	6	6	457		38

FRAME	UNITS	U -.001	AH	ES MIN	SQ KEY
440UC	IN	2.875	8.38	7.00	.750
	MM	73.03	213	178	19.05
440USC	IN	2.125	4.00	2.75	.500
	MM	53.98	102	70	12.70

FRAME	UNITS	C
444, 445UC	IN	45.75
	MM	1162
444, 445USC	IN	41.38
	MM	1051
447UC	IN	49.25
	MM	1251
447USC	IN	44.88
	MM	1140

FRAME	UNITS	B	K	BS	BV
444, 445U, USC	IN	19.50	6.00	8.25	16.00
	MM	495	152	210	406
447U, USC	IN	23.00	4.00	10.00	17.75
	MM	584	102	254	451

FRAME	UNITS	2F ±.03
444UC, USC	IN	14.50
	MM	368
445UC, USC	IN	16.50
	MM	419
447UC, USC	IN	20.00
	MM	508

TOLERANCES	
FACE RUNOUT	.007 T.I.R.
PERMISSIBLE ECCENTRICITY OF MOUNTING RABBET	.007 T.I.R.
PERMISSIBLE SHAFT RUNOUT	.003 T.I.R.

- 1: ALL ROUGH DIMENSIONS MAY VARY .25" DUE TO CASTING AND/OR FABRICATION VARIATIONS.
- 2: TAP SIZE AND BOLT PENETRATION ALLOWANCE.
- 3: ALL TAPPED HOLES ARE UNIFIED NATIONAL COARSE, RIGHT HAND THREAD.
- 4: CONDUIT BOX MAY BE LOCATED ON EITHER SIDE AND CONDUIT OPENING MAY BE LOCATED IN STEPS OF 90° REGARDLESS OF LOCATION. STANDARD AS SHOWN WITH CONDUIT OPENING DOWN
- 5: LARGEST MOTOR WIDTH.
- 6: TOLERANCES SHOWN ARE IN INCHES ONLY.

07-2766/B

**Nidec Motor Corporation**  
St. Louis, Missouri

INFORMATION DISCLOSED ON THIS DOCUMENT IS CONSIDERED PROPRIETARY AND SHALL NOT BE REPRODUCED OR DISCLOSED WITHOUT WRITTEN CONSENT OF NIDEC MOTOR CORPORATION



ISSUED BY  
**M. CHAUDHARI**  
APPROVED BY  
**R. KING**

IHP\_DP\_NMCA (MAR-2011) SOLIDEDGE