

EFFECTIVE:
05-MAY-16

DIMENSION PRINT
WITH NEMA "C" BRACKET
FRAME: 284, 286 TC, TSC
BASIC TYPE: CT

PRINT:
07-2777

SUPERSEDES:
09-JUN-11

SHEET:
1 OF 1

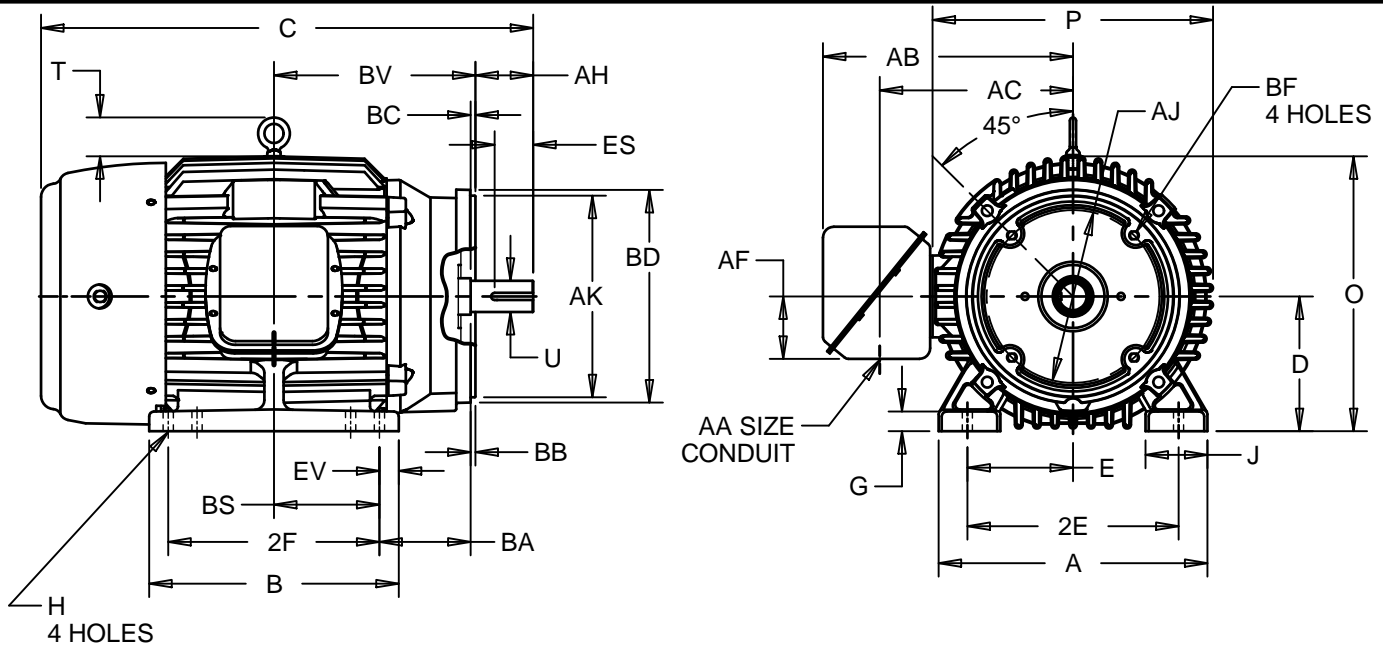

ALL DIMENSIONS ARE IN INCHES AND MILLIMETERS

UNITS	A	B	D -.06	E	2E ±.03	G	H +.05	J	O	P ⁵
IN	14.00	13.00	7.00	5.50	11.00	1.00	.53	2.88	14.28	14.59
MM	356	330	178	140	279	25	13	73	363	371

UNITS	T	AA	AB	AC	AF	AJ	AK -.003	BA	BB	BC	BD MAX
IN	2.03	2.00	13.00	9.63	3.25	9.000	10.500	4.75	.25	.25	11.25
MM	52		330	245	83	228.60	266.70	121	6	6	286

UNITS	BF ²	BS	BV	EV
IN	1/2-13 X .75	5.50	10.50	1.00
MM		140	267	25

FRAME	UNITS	C	U -.001	AH	ES MIN	SQ KEY
280TC	IN	27.00	1.875	4.38	3.28	.500
	MM	686	47.63	111	83	12.70
280TSC	IN	25.63	1.625	3.00	1.91	.375
	MM	651	41.28	76	49	9.53

FRAME	UNITS	2F ±.03
284TC, TSC	IN	9.50
	MM	241
286TC, TSC	IN	11.00
	MM	279

- 1: ALL ROUGH DIMENSIONS MAY VARY .25" DUE TO CASTING AND/OR FABRICATION VARIATIONS.
- 2: TAP SIZE AND BOLT PENETRATION ALLOWANCE.
- 3: ALL TAPPED HOLES ARE UNIFIED NATIONAL COARSE, RIGHT HAND THREAD.
- 4: CONDUIT BOX MAY BE LOCATED ON EITHER SIDE AND CONDUIT OPENING MAY BE LOCATED IN STEPS OF 90 DEGREES REGARDLESS OF LOCATION. STANDARD AS SHOWN WITH CONDUIT OPENING DOWN
- 5: LARGEST MOTOR WIDTH.
- 6: TOLERANCES SHOWN ARE IN INCHES ONLY.

TOLERANCES	
FACE RUNOUT	.004 T.I.R.
PERMISSIBLE ECCENTRICITY OF MOUNTING RABBET	.004 T.I.R.
PERMISSIBLE SHAFT RUNOUT	.002 T.I.R.

07-2777/B

Nidec Motor Corporation
St. Louis, Missouri

INFORMATION DISCLOSED ON THIS DOCUMENT IS CONSIDERED PROPRIETARY AND SHALL NOT BE REPRODUCED OR DISCLOSED WITHOUT WRITTEN CONSENT OF NIDEC MOTOR CORPORATION



ISSUED BY
R. KING
APPROVED BY
J. O'BRIEN

IHP_DP_NMCA (MAR-2011) SOLIDEDGE