

EFFECTIVE:
13-JUN-11

SUPERSEDES:
16-FEB-09

HORIZONTAL MOTORS

AUTOMOTIVE DUTY WITH ACCOMODATION FOR BRAKE

FRAME: 284, 286 U
BASIC TYPE: JAD, JDE

PRINT:
07-2785

SHEET:
1 OF 1

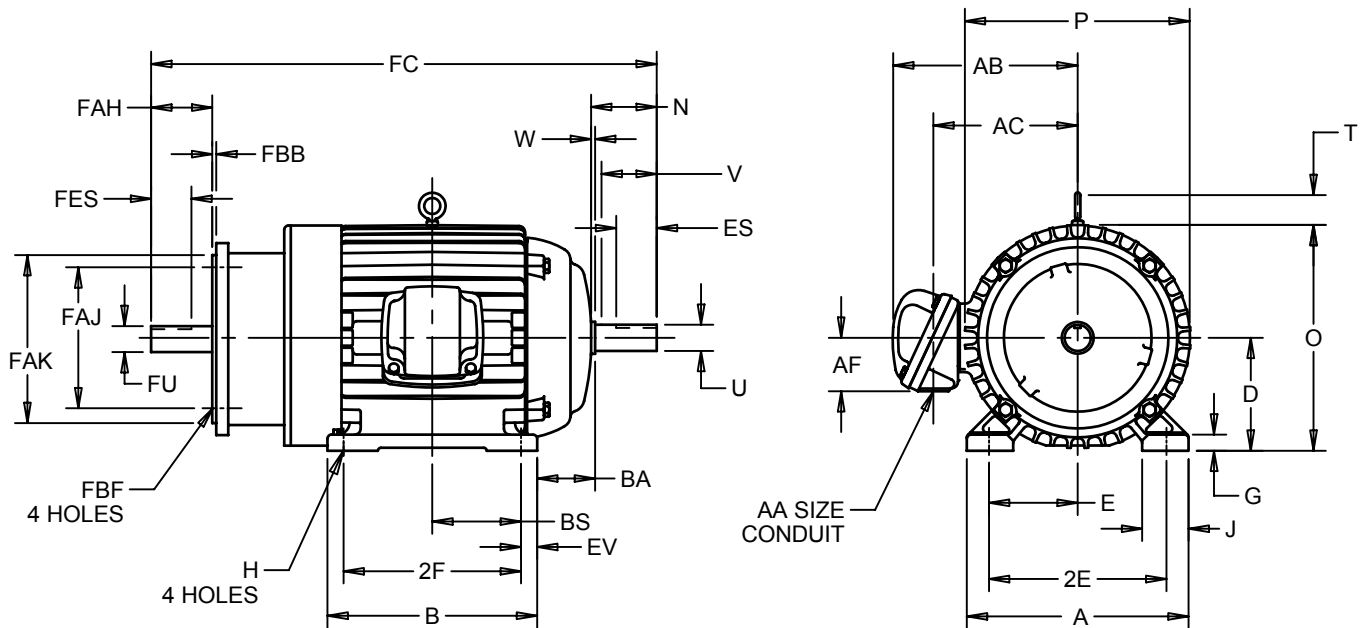

ALL DIMENSIONS ARE IN INCHES AND MILLIMETERS

UNITS	A	B	D -.06	E	2E ±.03	G	H +.05	J	N	O	P ²	T
IN	13.75	13.00	7.00	5.50	11.00	1.00	.53	2.88	5.25	14.00	14.94	2.03
MM	349	330	178	140	279	25	13	73	133	356	379	52

UNITS	U -.001	V MIN	W	AA	AB	AC	AF	BA	BS	ES MIN	EV
IN	1.625	4.63	.38	2.00 NPT	13.19	9.69	3.25	4.75	5.50	3.28	1.00
MM	41.28	118	10		335	246	83	121	140	83	25

UNITS	FC	FAH	FAJ	FAK -.003	FBB MIN	FBF	FES MIN	FU -.0005	PE SQ KEY	SE SQ KEY
IN	34.94	3.50	9.000	10.500	.25	1/2-13	3.41	1.3750	.375	.313
MM	887	89	228.60	266.70	6		87	34.925	9.53	7.95

FRAME	UNITS	2F ±.03
284U	IN	9.50
	MM	241
286U	IN	11.00
	MM	279

- 1: ALL ROUGH DIMENSIONS MAY VARY .25" DUE TO CASTING AND/OR FABRICATION VARIATIONS.
- 2: LARGEST MOTOR WIDTH.
- 3: TOLERANCES SHOWN ARE IN INCHES ONLY.
- 4: STANDARD ASSEMBLY POSITION F-1 IS SHOWN F-2 IS PROVIDED WHEN SPECIFIED. CONDUIT OPENING MAY BE LOCATED IN STEPS OF 90° REGARDLESS OF LOCATION. STANDARD AS SHOWN WITH CONDUIT OPENING DOWN
- 5: ALL TAPPED HOLES ARE UNIFIED NATIONAL COARSE, RIGHT HAND THREAD.
- 6: TAP SIZE AND BOLT PENETRATION ALLOWANCE.

TOLERANCES	
FACE RUNOUT	.004 T.I.R.
PERMISSIBLE ECCENTRICITY OF MOUNTING RABBET	.004 T.I.R.
PERMISSIBLE SHAFT RUNOUT	.002 T.I.R.

07-2785/A

Nidec Motor Corporation
St. Louis, Missouri

INFORMATION DISCLOSED ON THIS DOCUMENT IS CONSIDERED PROPRIETARY AND SHALL NOT BE REPRODUCED OR DISCLOSED WITHOUT WRITTEN CONSENT OF NIDEC MOTOR CORPORATION



ISSUED BY
A. HINGANKAR
APPROVED BY
R. KING

IHP_DP_NMCA (MAR-2011) SOLIDEDGE