

EFFECTIVE:
14-JUN-11

SUPERSEDES:
20-JUL-10

HORIZONTAL MOTORS

TEFC - VARIDYNE
FRAME: 182, 184TC
BASIC TYPE: CTI

PRINT:
07-2809

SHEET:
1 OF 1

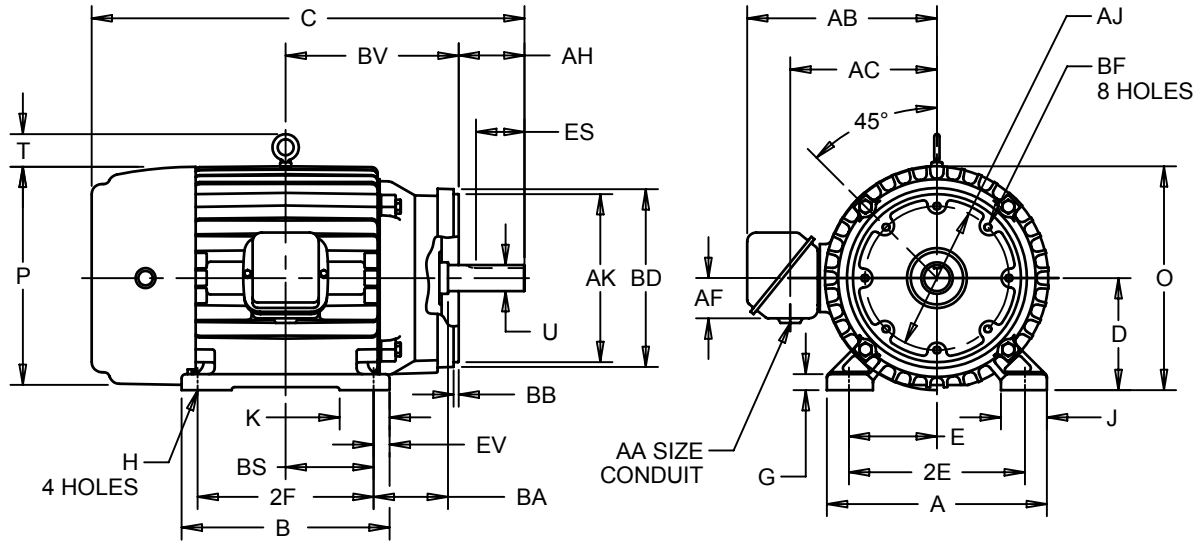

ALL DIMENSIONS ARE IN INCHES AND MILLIMETERS

UNITS	A	B	C	D -.06	E	2E ±.03	G	H +.05	J	O	P ⁵
IN	9.00	6.75	15.56	4.50	3.75	7.50	.50	.41	1.50	9.22	9.13
MM	229	171	395	114	95	191	13	10	38	234	232

UNITS	T	U -.0005	V MIN	AA	AB	AC	AF	AH	AJ	AK -.003
IN	2.03	1.1250	2.50	.75 NPT	7.97	5.75	2.00	2.62	7.250	8.500
MM	52	28.575	64		202	146	51	67	184.15	215.90

UNITS	BA ⁷	BB	BD MAX	BS	BF ²	BV	ES MIN	EV	SQ KEY
IN	2.75	.25	8.88	2.75	.500-13	5.63	1.78	.63	.250
MM	70	6	226	70		143	45	16	6.35

FRAME	UNITS	2F ±.03
182TC	IN	4.50
	MM	114
184TC	IN	5.50
	MM	140

- 1: ALL ROUGH DIMENSIONS MAY VARY BY .25" DUE TO CASTING AND/OR FABRICATION VARIATIONS.
- 2: TAP SIZE AND BOLT PENETRATION ALLOWANCE.
- 3: ALL TAPPED HOLES ARE UNIFIED NATIONAL COARSE, RIGHT HAND THREAD.
- 4: CONDUIT BOX MAY BE LOCATED ON EITHER SIDE OF MOTOR. CONDUIT OPENINGS MAY BE LOCATED IN STEPS OF 90° REGARDLESS OF LOCATION. STANDARD AS SHOWN WITH CONDUIT OPENING DOWN.
- 5: LARGEST MOTOR WIDTH.
- 6: TOLERANCES SHOWN ARE IN INCHES ONLY.
- 7: NON-NEMA BA.

TOLERANCES	
FACE RUNOUT	.004 T.I.R.
PERMISSIBLE ECCENTRICITY OF MOUNTING RABBET	.004 T.I.R.
PERMISSIBLE SHAFT RUNOUT	.002 T.I.R.

07-2809/B

Nidec Motor Corporation
St. Louis, Missouri

INFORMATION DISCLOSED ON THIS DOCUMENT IS CONSIDERED PROPRIETARY AND SHALL NOT BE REPRODUCED OR DISCLOSED WITHOUT WRITTEN CONSENT OF NIDEC MOTOR CORPORATION



ISSUED BY
A. HINGANKAR
APPROVED BY
R. KING

IHP_DP_NMCA (MAR-2011) SOLIDEDGE