

EFFECTIVE:
15-JUN-11

HORIZONTAL MOTORS

AUTOMOTIVE DUTY WITH ACCOMODATION FOR BRAKE

PRINT:
07-2841

SUPERSEDES:
25-MAY-09

FRAME: 254, 256 U
BASIC TYPE: JAD, JDE

SHEET:
1 OF 1

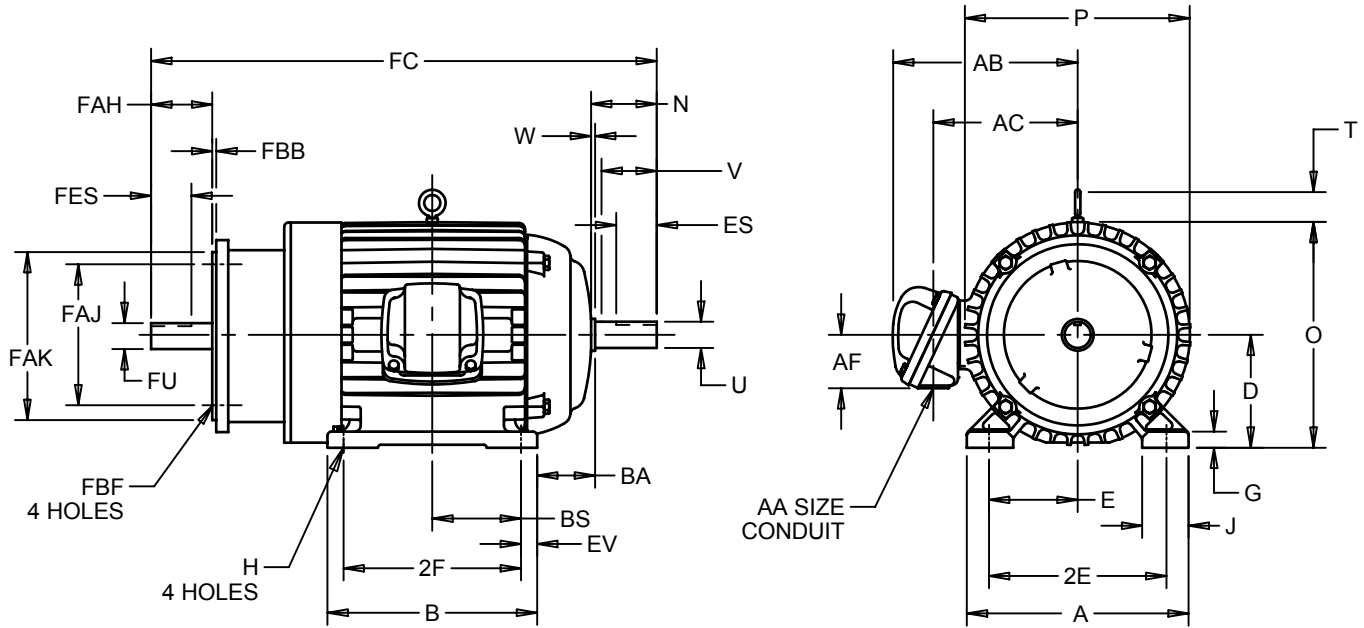

ALL DIMENSIONS ARE IN INCHES AND MILLIMETERS

UNITS	A	B	D -.06	E	2E ±.03	G	H +.05	J	N	O	P ²	T
IN	12.13	12.00	6.25	5.00	10.00	.88	.53	2.25	4.13	12.91	12.41	2.03
MM	308	305	159	127	254	22	13	57	105	328	315	52

UNITS	U -.0005	V MIN	W	AA	AB	AC	AF	BA	BS	ES MIN	EV
IN	1.3750	3.50	.38	1.50 NPT	11.56	8.56	2.63	4.25	5.00	2.75	1.00
MM	34.925	90	10		294	217	67	108	127	70	25

UNITS	FC	FAH	FAJ	FAK -.003	FBB MIN	FBF	FES MIN	FU -.0005	PE SQ KEY	SE SQ KEY
IN	30.25	2.75	7.25	8.5	.25	1/2-13	2.41	1.1300	.313	.250
MM	768	70	184	216	6		61	28.702	8	6

FRAME	UNITS	2F ±.03
254U	IN	8.25
	MM	210
256U	IN	10.00
	MM	254

- 1: ALL ROUGH DIMENSIONS MAY VARY .25" DUE TO CASTING AND/OR FABRICATION VARIATIONS.
- 2: LARGEST MOTOR WIDTH.
- 3: TOLERANCES SHOWN ARE IN INCHES ONLY.
- 4: STANDARD ASSEMBLY POSITION F-1 IS SHOWN F-2 IS PROVIDED WHEN SPECIFIED. CONDUIT OPENING MAY BE LOCATED IN STEPS OF 90° REGARDLESS OF LOCATION. STANDARD AS SHOWN WITH CONDUIT OPENING DOWN
- 5: ALL TAPPED HOLES ARE UNIFIED NATIONAL COARSE, RIGHT HAND THREAD.
- 6: TAP SIZE AND BOLT PENETRATION ALLOWANCE.

TOLERANCES	
FACE RUNOUT	.004 T.I.R.
PERMISSIBLE ECCENTRICITY OF MOUNTING RABBET	.004 T.I.R.
PERMISSIBLE SHAFT RUNOUT	.002 T.I.R.

07-2841/A

Nidec Motor Corporation
St. Louis, Missouri

INFORMATION DISCLOSED ON THIS DOCUMENT
IS CONSIDERED PROPRIETARY AND SHALL NOT BE
REPRODUCED OR DISCLOSED WITHOUT WRITTEN
CONSENT OF NIDEC MOTOR CORPORATION



ISSUED BY
A. HINGANKAR
APPROVED BY
R. KING

IHP_DP_NMCA (MAR-2011) SOLIDEDGE