

EFFECTIVE:
16-JUN-11

SUPERSEDES:
31-JUL-09

HORIZONTAL MOTORS
TENV - VARIDYNE
FRAME: 213, 215TC
BASIC TYPE: CTNX - CONVERSION

PRINT:
07-2887

SHEET:
1 OF 1

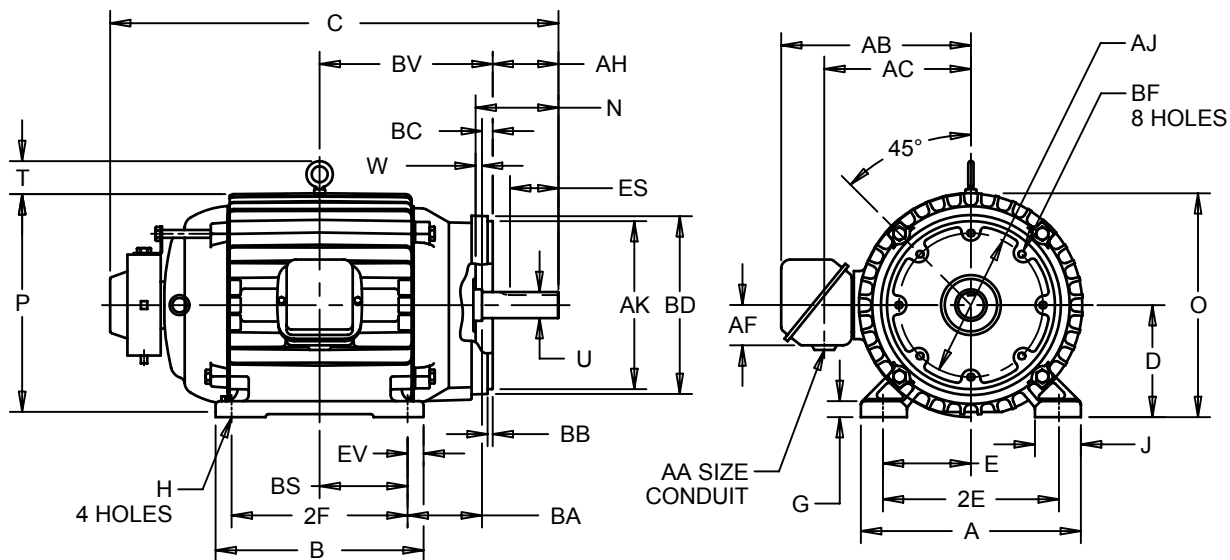

ALL DIMENSIONS ARE IN INCHES AND MILLIMETERS

UNITS	A	B	C	D -.06	E	2E ±.03	G	H +.05	J	N	O	P ⁵
IN	10.50	8.50	19.22	5.25	4.25	8.50	.50	.41	1.75	3.56	10.81	10.88
MM	267	216	488	133	108	216	13	10	44	90	275	276

UNITS	T	U -.0005	W	AA 1.00 NPT	AB	AC	AF	AH	AJ	AK -.003	BA ⁷
IN	2.03	1.3750	.19		8.88	7.06	2.00	3.12	7.250	8.500	3.50
MM	52	34.925	5		225	179	51	79	184.15	215.90	89

UNITS	BB	BC	BD MAX	BF ² 1/2-13 X .75	BV	BS	ES MIN	EV	XZ	SQ KEY
IN	.25	.25	9.00		8.00	3.50	2.41	.75	10.88	.313
MM	6	6	229		203	89	61	19	276	7.95

FRAME	UNITS	2F ±.03
213TC	IN	5.50
	MM	140
215TC	IN	7.00
	MM	178

- 1: ALL ROUGH DIMENSIONS MAY VARY BY .25" DUE TO CASTING AND/OR FABRICATION VARIATIONS.
- 2: TAP SIZE AND BOLT PENETRATION ALLOWANCE.
- 3: ALL TAPPED HOLES ARE UNIFIED NATIONAL COARSE, RIGHT HAND THREAD.
- 4: CONDUIT BOX MAY BE LOCATED ON EITHER SIDE OF MOTOR. CONDUIT OPENINGS MAY BE LOCATED IN STEPS OF 90° REGARDLESS OF LOCATION. STANDARD AS SHOWN WITH CONDUIT OPENING DOWN.
- 5: LARGEST MOTOR WIDTH.
- 6: TOLERANCES SHOWN ARE IN INCHES ONLY.
- 7: NON-NEMA BA.
- 8: ENCODER CONNECTOR IS SHOWN OUT OF POSITION.

TOLERANCES	
FACE RUNOUT	.004 T.I.R.
PERMISSIBLE ECCENTRICITY OF MOUNTING RABBET	.004 T.I.R.
PERMISSIBLE SHAFT RUNOUT	.002 T.I.R.

07-2887-A

Nidec Motor Corporation
St. Louis, Missouri

INFORMATION DISCLOSED ON THIS DOCUMENT IS CONSIDERED PROPRIETARY AND SHALL NOT BE REPRODUCED OR DISCLOSED WITHOUT WRITTEN CONSENT OF NIDEC MOTOR CORPORATION



ISSUED BY
A. HINGANKAR
APPROVED BY
R. KING

IHP_DP_NMCA (MAR-2011) SOLIDEDGE