

EFFECTIVE:
01-APR-11

HORIZONTAL MOTORS

WITH NEMA "C" BRACKET

FRAME: 213, 215 TC
BASIC TYPE: LC, NC

PRINT:
07-2931

SUPERSEDES:
14-DEC-09

SHEET:
1 OF 1

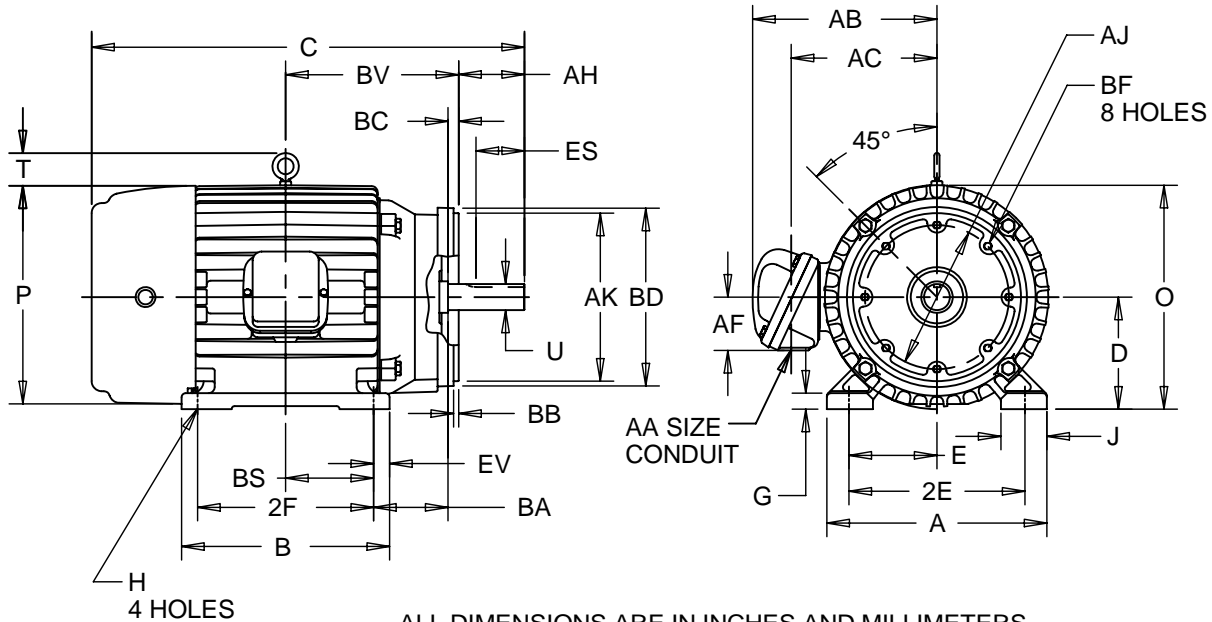

ALL DIMENSIONS ARE IN INCHES AND MILLIMETERS

UNITS	A	B	C	D -.06	E	2E ±.03	G	H +.05	J	O
IN	10.50	8.50	20.75	5.25	4.25	8.50	.50	.41	1.75	10.94
MM	267	216	527	133	108	216	13	10	44	278

UNITS	P ⁵	T	U -.0005	AA	AB	AC	AF	AH	AJ	AK	BA
IN	11.19	2.03	1.3750	1.00 NPT	9.16	6.81	2.63	3.13	7.25	8.500	4.25
MM	284	51	34.925		233	173	67	80	184	216.90	108

UNITS	BB	BC	BD MAX	BS	BF ²	BV	ES MIN	EV	SQ KEY
IN	.25	.25	9.00	3.50	1/2-13 X .75	8.00	2.41	0.75	.313
MM	6	6	229	89		203	61	19	7.95

FRAME	UNITS	2F ±.03
213 TC	IN	5.50
	MM	140
215 TC	IN	7.00
	MM	178

- 1: ALL ROUGH DIMENSIONS MAY VARY BY .25" DUE TO CASTING AND/OR FABRICATION VARIATIONS.
- 2: TAP SIZE AND BOLT PENETRATION ALLOWANCE.
- 3: ALL TAPPED HOLES ARE UNIFIED NATIONAL COARSE, RIGHT HAND THREAD.
- 4: CONDUIT BOX MAY BE LOCATED ON EITHER SIDE OF MOTOR. CONDUIT OPENINGS MAY BE LOCATED IN STEPS OF 90 DEGREES REGARDLESS OF LOCATION. STANDARD AS SHOWN WITH CONDUIT OPENING DOWN.
- 5: LARGEST MOTOR WIDTH.
- 6: TOLERANCES SHOWN ARE IN INCHES ONLY.

TOLERANCES	8.5 AK
FACE RUNOUT	.004 T.I.R.
PERMISSIBLE ECCENTRICITY OF MOUNTING RABBET	.004 T.I.R.
PERMISSIBLE SHAFT RUNOUT	.002 T.I.R.
FOR SPECIAL SHAFT RUNOUT	.001 T.I.R.
TOLERANCE ON "AK" DIMENSION	-.003

07-2931/A ECO 46423-00

Nidec Motor Corporation
St. Louis, Missouri

INFORMATION DISCLOSED ON THIS DOCUMENT
IS CONSIDERED PROPRIETARY AND SHALL NOT BE
REPRODUCED OR DISCLOSED WITHOUT WRITTEN
CONSENT OF NIDEC MOTOR CORPORATION



ISSUED BY
R. KING
APPROVED BY
K. POTTER

IHP_DP_NMCA (MAR-2011) SOLIDEDGE