

EFFECTIVE:  
**16-APR-15**

**DIMENSION PRINT**  
TEFC - VERTICALLY MOUNTED  
FRAME: 280TC  
BASIC TYPE: TCEF, CEF

PRINT:  
**07-3058**

SUPERSEDES:  
**20-DEC-13**

SHEET:  
**1 OF 1**

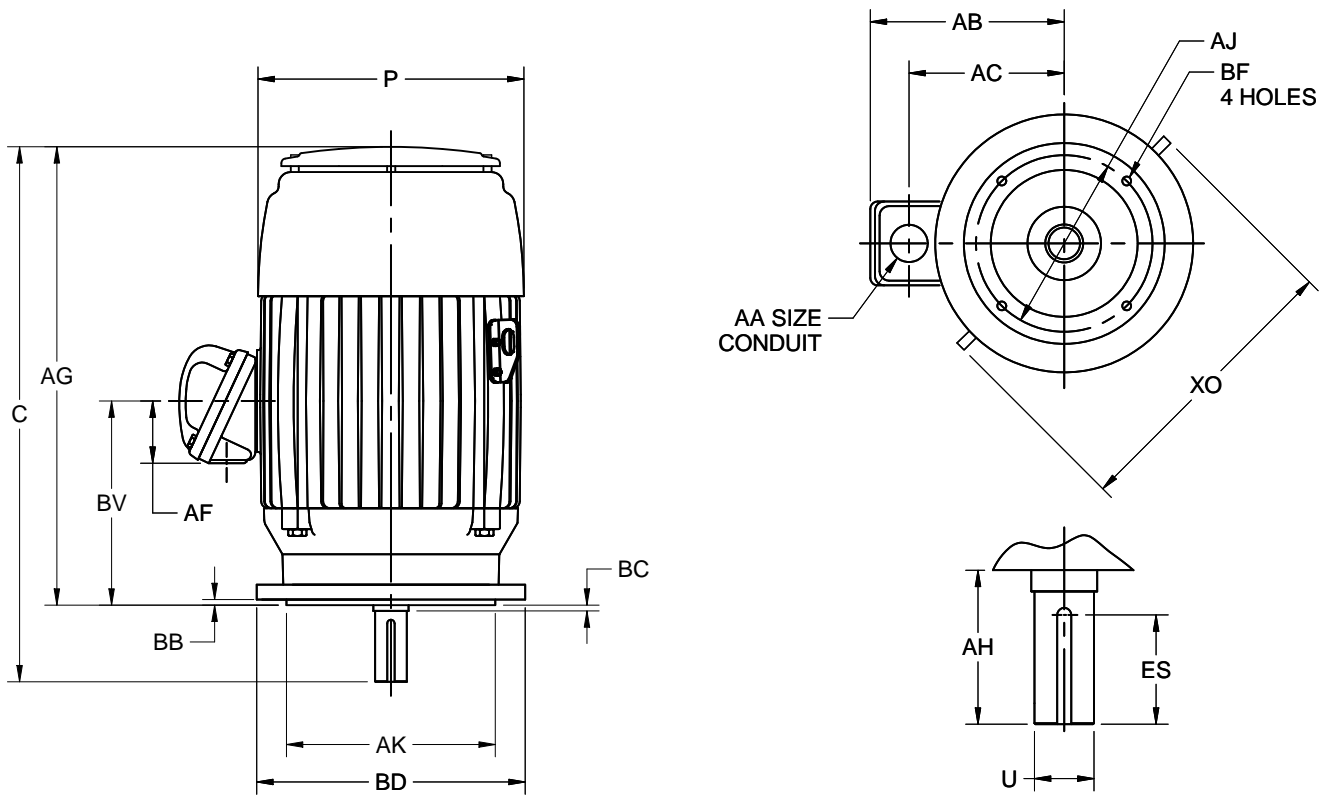

ALL DIMENSIONS ARE IN INCHES AND MILLIMETERS

UNITS	C	P <sup>2</sup>	U -.001	AA	AB	AC	AF	AG	AH	AJ	AK -.003	BB MIN
IN	29.65	14.59	1.875	1 1/2 NPT	11.94	8.94	2.63	25.27	4.38	9.000	10.500	.25
MM	753	371	47.63		303	227	67	642	111	228.60	266.70	6

UNITS	BC	BD MAX	BF <sup>3</sup>	BV	ES MIN	SQ KEY	XO
IN	.25	11.25	1/2-13 X .75	10.50	3.28	.500	18.52
MM	6	286		267	83	12.70	470

1. ALL ROUGH DIMENSIONS MAY VARY BY .25" DUE TO CASTING AND/OR FABRICATION VARIATIONS.
2. LARGEST MOTOR WIDTH.
3. TAP SIZE AND BOLT PENETRATION ALLOWANCE.
4. ALL TAPPED HOLES ARE UNIFIED NATIONAL COARSE, RIGHT HAND THREAD.
5. CONDUIT OPENING MAY BE LOCATED IN STEPS OF 90 DEGREES, STANDARD AS SHOWN WITH CONDUIT OPENING DOWN.
6. TOLERANCES SHOWN ARE IN INCHES ONLY.

TOLERANCES	
FACE RUNOUT	.004 T.I.R.
PERMISSIBLE ECCENTRICITY OF MOUNTING RABBET	.004 T.I.R.
PERMISSIBLE SHAFT RUNOUT	.002 T.I.R.
FOR SPECIAL SHAFT RUNOUT	.001 T.I.R.

07-3058/A

**Nidec Motor Corporation**  
St. Louis, Missouri

INFORMATION DISCLOSED ON THIS DOCUMENT IS CONSIDERED PROPRIETARY AND SHALL NOT BE REPRODUCED OR DISCLOSED WITHOUT WRITTEN CONSENT OF NIDEC MOTOR CORPORATION



ISSUED BY  
**F. CRUZ**  
APPROVED BY  
**K. VALADEZ**

IHP\_DP\_NMCA (MAR-2011) SOLIDEDGE