

EFFECTIVE:
24-JAN-17

DIMENSION PRINT
TEFC W/ BRAKE
FRAME: 449
BASIC TYPE: J,JC

PRINT:
07-3285

SUPERSEDES:
NEW

SHEET:
1 OF 1

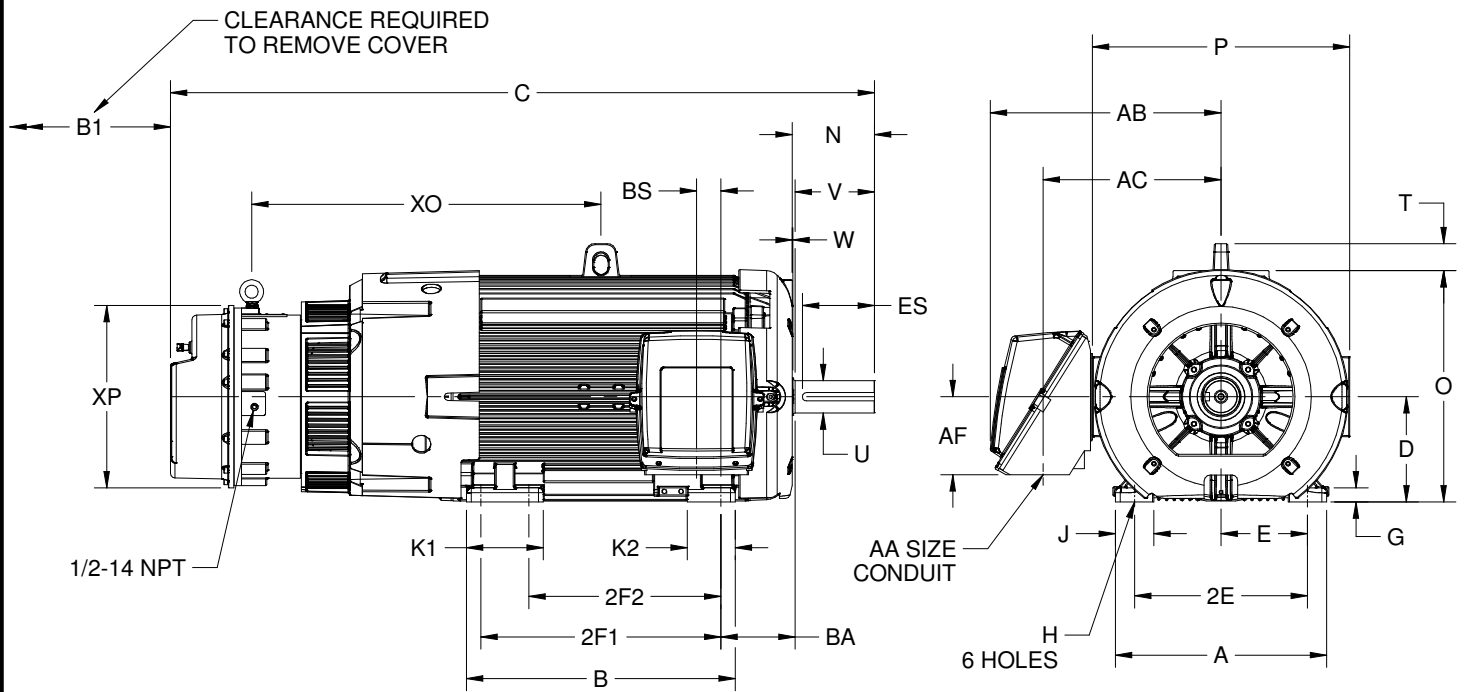

ALL DIMENSIONS ARE IN INCHES AND MILLIMETERS

UNITS	A	B	B1	D	E	2E	2F1	2F2	G	H	J	K1
IN	22.00	28.00	6.00	11.00	9.00	18.00	25.00	20.00	1.50	.81	4.00	8.00
MM	559	711	152	279	229	457	635	508	38	21	102	203

UNITS	K2	O	P ²	T	AB	AC	AF	BA	BS	XO	XP
IN	5.00	24.06	26.50	2.88	24.25	18.53	8.06	7.50	2.50	31.19	19.00
MM	127	611	673	73	616	471	205	191	64	792	483

FRAME	UNITS	C	N	U	V	W	ES	SQ
449T	IN	73.31	8.94	3.375	8.25	.44	7.00	.875
	MM	1862	227	85.73	210	11	178	22.23
449TL	IN	75.31	10.63	4.375	10.25	.12	8.50	1.000
	MM	1913	270	111.13	260	3	216	25.40
449TM	IN	69.56	5.19	2.875	4.50	.44	3.63	.750
	MM	1767	132	73.03	114	11	92	19.05
449TS	IN	69.56	5.19	2.375	4.50	.44	3.13	.625
	MM	1767	132	60.33	114	11	80	15.88

AA
2 NPT
2 1/2 NPT
3 NPT
3 1/2 NPT
4 NPT

1. DIMENSIONS MAY VARY BY .25" DUE TO CASTING AND/OR FABRICATION VARIATIONS.
2. LARGEST MOTOR WIDTH.
3. STANDARD ASSEMBLY POSITION F-1 IS SHOWN. F-2 IS PROVIDED WHEN SPECIFIED. CONDUIT OPENINGS MAY BE LOCATED IN STEPS OF 90 DEGREES REGARDLESS OF LOCATION. STANDARD AS SHOWN WITH CONDUIT OPENING DOWN.
4. TOLERANCES SHOWN ARE IN INCHES ONLY.

NOTE: THIS DIMENSION PRINT IS GOOD FOR STEARNS SERIES 1-086-0XX-02, IP54 ENCLOSURE, RANGING FROM 500 THRU 1000 LB-FT.

Nidec Motor Corporation
St. Louis, Missouri

INFORMATION DISCLOSED ON THIS DOCUMENT IS CONSIDERED PROPRIETARY AND SHALL NOT BE REPRODUCED OR DISCLOSED WITHOUT WRITTEN CONSENT OF NIDEC MOTOR CORPORATION



ISSUED BY
O. RODRIGUEZ
APPROVED BY
T. PALLETT