

EFFECTIVE:
02-NOV-18

SUPERSEDES:
NEW

DIMENSION PRINT

TEFC - JET PUMP

FRAME: 56J

BASIC TYPE: UTF

ITEM:
07-3351

SHEET:
1 OF 1

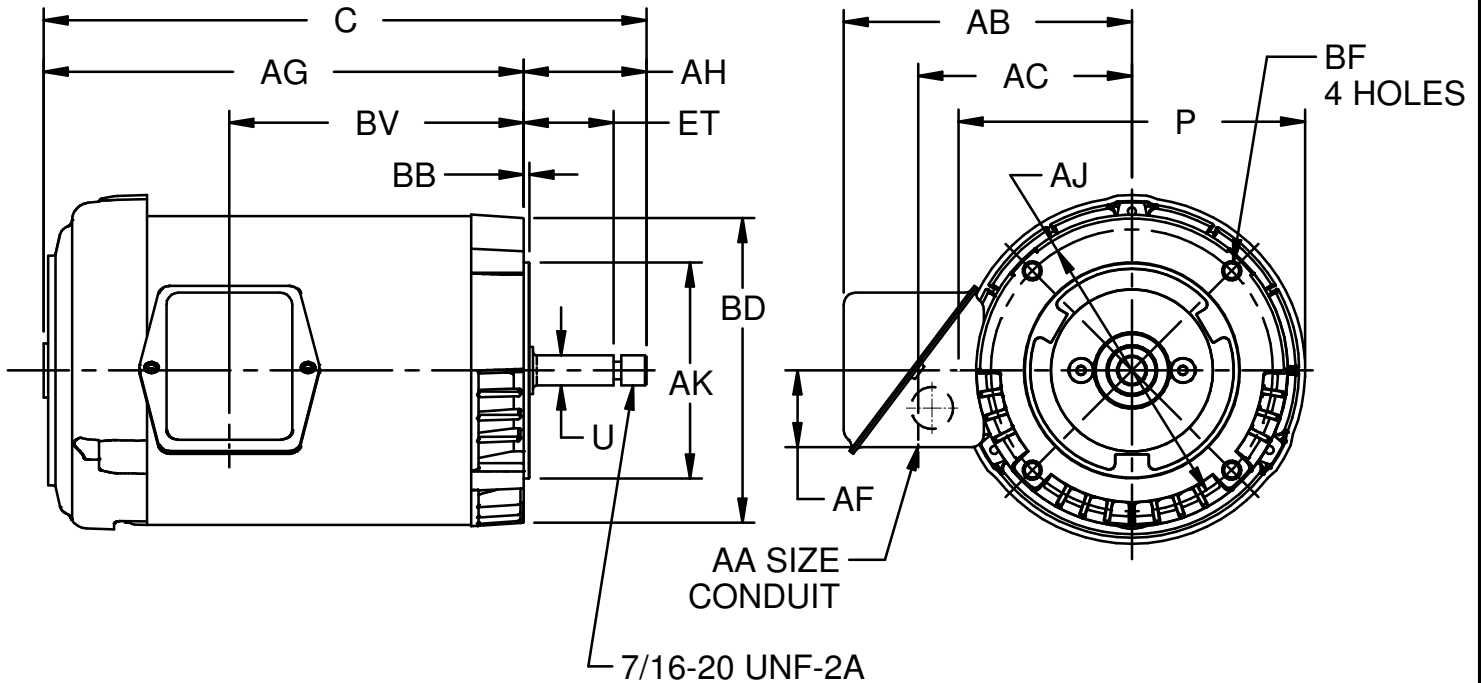

ALL DIMENSIONS ARE IN INCHES AND MILLIMETERS

UNITS	C	P	U -.0005	AA	AB	AC	AF	AG	AH	AJ	AK -.003
IN	12.56	7.28	.6250	.75	6.13	4.53	1.59	10.00	2.56	5.875	4.500
MM	319	185	15.875	19	156	115	40	254	65	149.23	114.30

UNITS	BB MIN	BD MAX	BF ³	BV	ET ±.015
IN	.13	6.50	.375-16 x .75	6.13	1.875
MM	3	165		156	47.62

- 1: DIMENSIONS MAY VARY BY .25" DUE TO CASTING AND/OR FABRICATION VARIATIONS.
- 2: LARGEST MOTOR WIDTH.
- 3: ALL TAPPED HOLES ARE UNIFIED NATIONAL COARSE, RIGHT HAND THREAD.
- 4: TAP SIZE AND BOLT PENETRATION ALLOWANCE.
- 5: BASIC CONDUIT FITTING SIZE. HOLE OPENING ON THE SIDE OF THE CONDUIT BOX (REPRESENTED BY A DASHED CIRCLE) WILL ACCEPT A .50 BASIC CONDUIT FITTING.
- 6: THE CONDUIT BOX MAY BE LOCATED ON EITHER SIDE OF THE MOTOR. THE CONDUIT OPENING(S) MAY BE LOCATED IN STEPS OF 180 DEGREES REGARDLESS OF LOCATION. STANDARD LOCATION IS SHOWN WITH THE CONDUIT OPENING DOWN.
- 7: TOLERANCES SHOWN ARE IN INCHES ONLY.
- 8: FRAME REFERENCE 6.75/56

07-3351/-

Nidec Motor Corporation
St. Louis, Missouri

INFORMATION DISCLOSED ON THIS DOCUMENT IS CONSIDERED PROPRIETARY AND SHALL NOT BE REPRODUCED OR DISCLOSED WITHOUT WRITTEN CONSENT OF NIDEC MOTOR CORPORATION



ISSUED BY
R. KING
APPROVED BY
J. HAGENE

IHP_DP_NMCA (MAR-2011) SOLIDEDGE