

EFFECTIVE:  
28-FEB-20

SUPERSEDES:  
NEW

**DIMENSION PRINT**  
STEEL EDGE C-FACE WITH OVERSIZE OUTLET BOX  
FRAME: 254, 256TC  
BASIC TYPE: SE

PRINT:  
07-3428-01

SHEET:  
1 OF 1

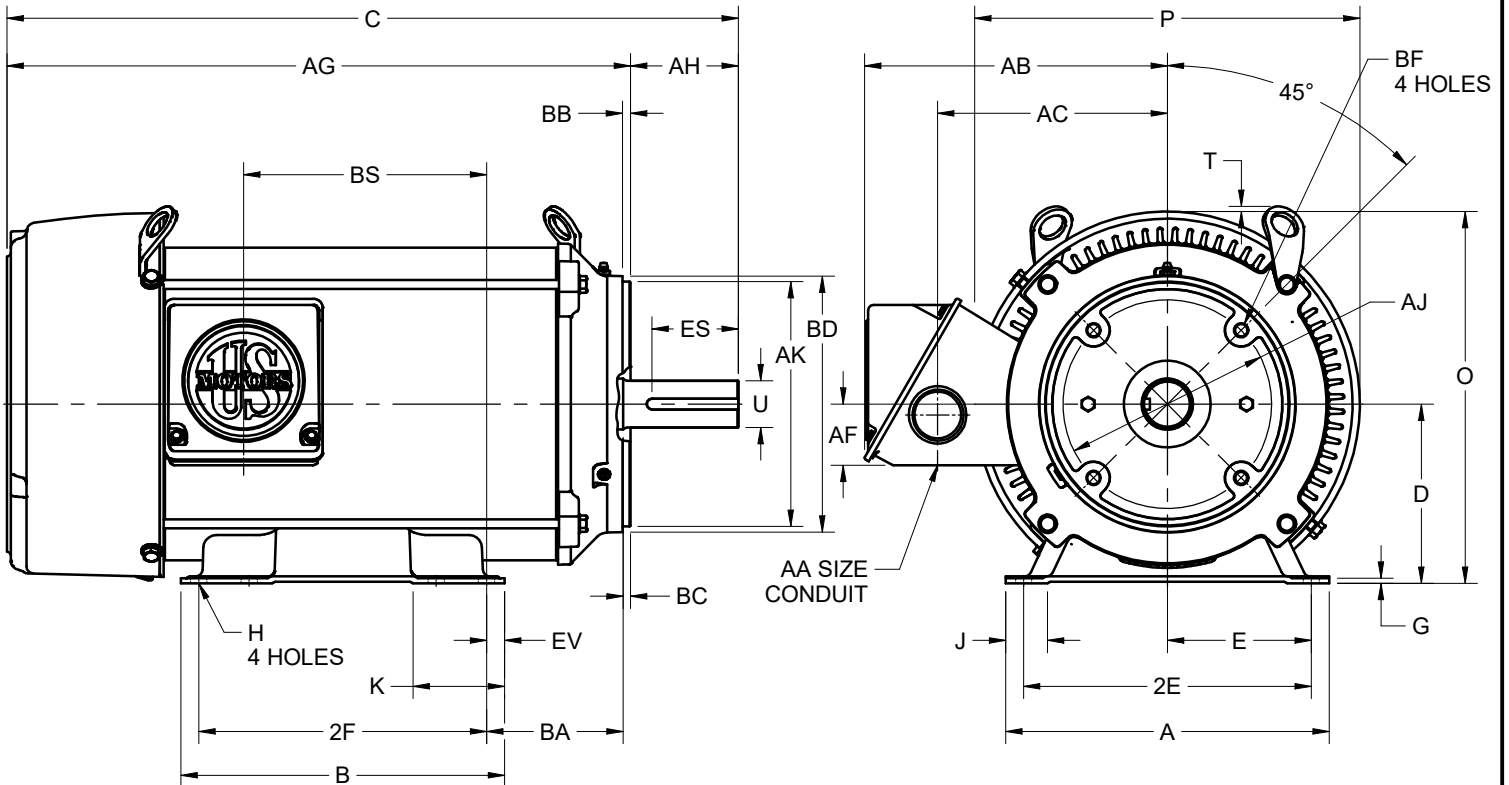

ALL DIMENSIONS ARE IN INCHES AND MILLIMETERS

UNITS	A	C	D -.06	E	2E ±.03	G	H +.05	J	K	O	P <sup>2</sup>	T
IN	11.25	25.41	6.25	5.00	10.00	.19	.53	1.44	1.38	12.94	13.38	.19
MM	286	645	159	127	254	5	13	37	35	329	340	5

UNITS	U -.001	AA <sup>5</sup>	AB	AC	AF	AG	AH	AJ	AK -.003	BA	BB MIN	BC
IN	1.625	1.50	10.53	8.00	2.13	21.66	3.75	7.250	8.500	4.75	.25	.25
MM	41.28		267	203	54	550	95	184.15	215.90	121	6	6

UNITS	BD MAX	BF <sup>3,4</sup>	BS	EV	ES MIN	SQ KEY
IN	10.00	1/2-13 X .75	8.44	.63	2.91	.375
MM	254		214	16	74	9.53

FRAME	UNITS	B	2F ±.03
254TC	IN	9.50	8.25
	MM	241	210
256TC	IN	11.25	10.00
	MM	286	254

TOLERANCES	
FACE RUNOUT	.004 TIR
PERMISSIBLE ECCENTRICITY OF MOUNTING RABBET	.004 TIR
PERMISSIBLE SHAFT RUNOUT	.002 TIR

1. DIMENSIONS MAY VARY .25" DUE TO CASTING AND/OR FABRICATION VARIATIONS
2. LARGEST MOTOR WIDTH
3. ALL TAP HOLES ARE UNIFIED NATIONAL COARSE, RIGHT HAND THREAD
4. TAP SIZE AND BOLT PENETRATION ALLOWANCE
5. BASIC CONDUIT FITTING SIZE. CONDUIT OPENING ON THE SIDE OF THE CONDUIT BOX WILL ACCEPT 1-1/2 NPT CONDUIT FITTING
6. CONDUIT OPENING(S) MAY BE LOCATED IN STEPS OF 180° REGARDLESS OF LOCATION. STANDARD LOCATION IS SHOWN WITH CONDUIT OPENING DOWN
7. TOLERANCES ARE SHOWN IN INCHES ONLY
8. FRAME REFERENCE: 14.000/254//256

07-3428-01/-

**Nidec Motor Corporation**  
St. Louis, Missouri

INFORMATION DISCLOSED ON THIS DOCUMENT IS CONSIDERED PROPRIETARY AND SHALL NOT BE REPRODUCED OR DISCLOSED WITHOUT WRITTEN CONSENT OF NIDEC MOTOR CORPORATION



ISSUED BY  
**R. TIMMERMANN**  
APPROVED BY  
**P. HOGG**

IHP\_DP\_NMCA (MAR-2011) SOLIDEDGE