

EFFECTIVE:  
02-MAR-11

**VERTICAL MOTORS**  
EXPLOSION PROOF  
FRAME: 284,286TP,TPA,TPH  
BASIC TYPE: LU

PRINT:  
09-2305

SUPERSEDES:  
30-AUG-01

SHEET:  
1 OF 1

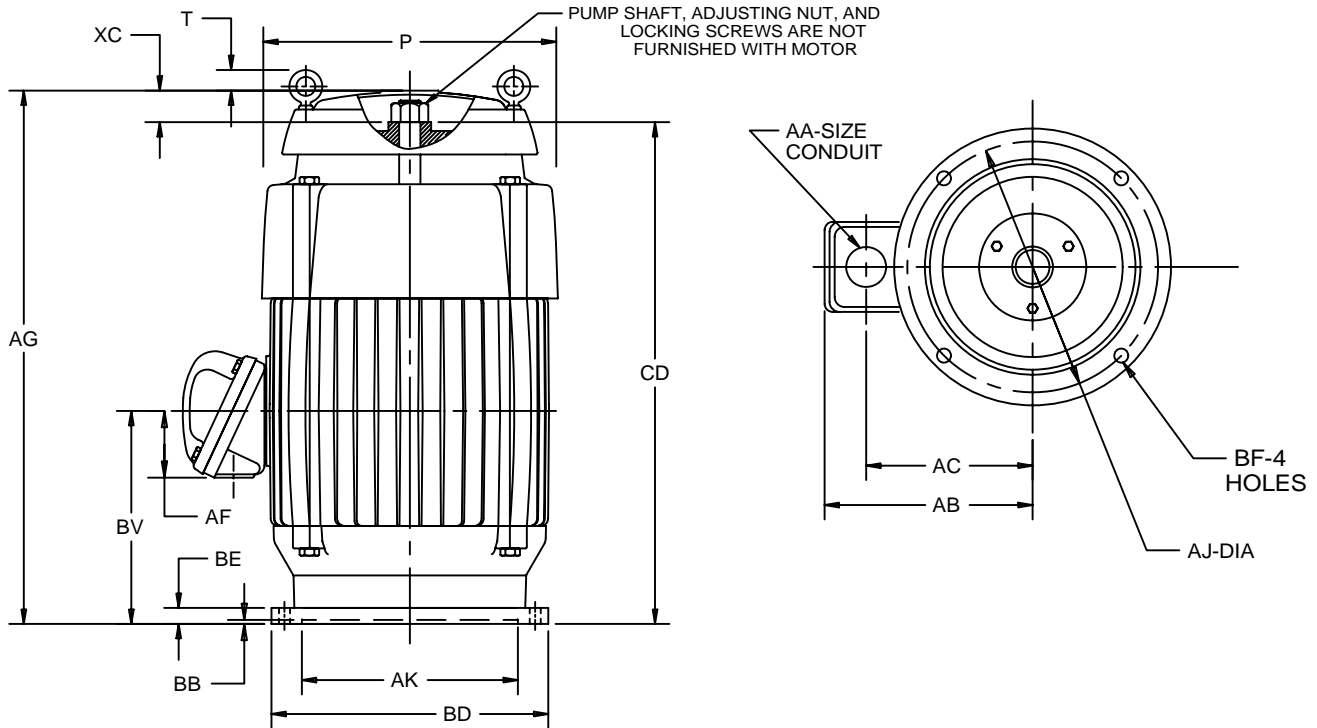

ALL DIMENSIONS ARE IN INCHES & MILLIMETERS

BASIC FRAME	UNITS	P <sup>2</sup>	T	AA	AB	AC	AF	AG	BE	BV	CD	XC
280	IN	14.75	-1.31	2 NPT	13.19	9.69	3.88	32.63	.91	11.19	26.56	5.88
	mm	375	-33		335	246	99	829	23	284	675	149

FRAME	UNITS	AJ	AK	BB MIN	BD MAX	BF
284,286TP	IN	9.125	8.250	.19	10.00	.44
	mm	231.78	209.55	5	254	11
284,286TPA	IN	9.125	8.250	.19	12.00	.44
	mm	231.78	209.55	5	305	11
284,286TPH	IN	14.750	13.500	.25	16.50	.69
	mm	374.65	342.90	6	419	18

TOLERANCES	8.250 AK	13.500 AK
"AK" DIMENSION	-.000;+.003	-.000;+.005
FACE RUNOUT	.004 F.I.R.	.007 F.I.R.
PERMISSIBLE ECCENTRICITY OF MOUNTING RABBET	.004 F.I.R.	.007 F.I.R.

- 1: ALL ROUGH CASTING DIMENSIONS MAY VARY BY .25" DUE TO CASTING VARIATIONS.
- 2: LARGEST MOTOR WIDTH.
- 3: CONDUIT BOX MAY BE LOCATED IN STEPS OF 90° STANDARD AS SHOWN WITH CONDUIT OPENING DOWN.
- 4: (-) MINUS SIGN INDICATES EYEBOLT IS BELOW THE TOP OF THE UNIT.
- 5: TOLERANCES SHOWN ARE IN INCHES ONLY.

09-2305/A

**Nidec Motor Corporation**  
St. Louis, Missouri

INFORMATION DISCLOSED ON THIS DOCUMENT IS CONSIDERED PROPRIETARY AND SHALL NOT BE REPRODUCED OR DISCLOSED WITHOUT WRITTEN CONSENT OF NIDEC MOTOR CORPORATION



ISSUED BY  
**R. KING**  
APPROVED BY  
**K. POTTER**

IHP\_DP\_NMCA (MAR-2011) SOLIDEDGE