

EFFECTIVE:  
**06-MAY-11**

**VERTICAL MOTORS**  
WEATHER PROTECTED TYPE 1  
FRAME: 404, 405TCV  
BASIC TYPE: RV

PRINT:  
**09-2330**

SUPERSEDES:  
**18-OCT-01**

SHEET:  
**1 OF 1**

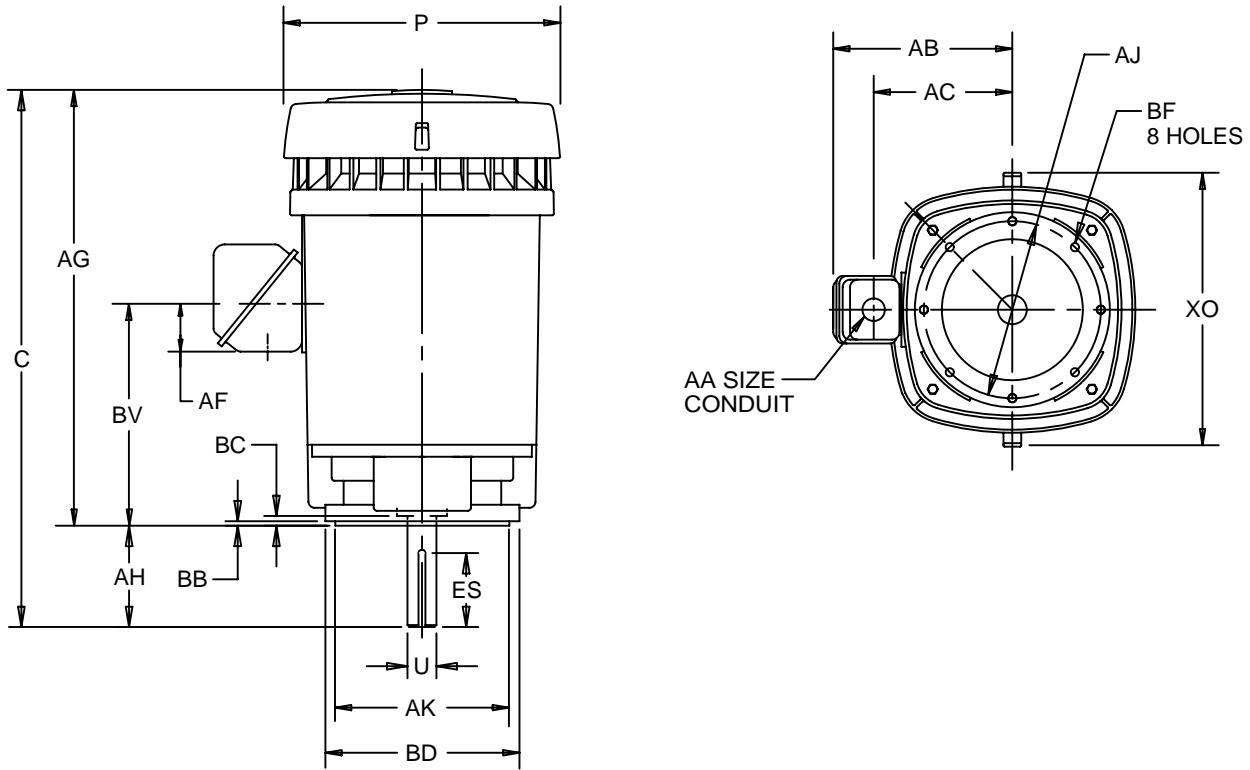

ALL DIMENSIONS ARE IN INCHES AND MILLIMETERS

UNITS	C	P <sup>2</sup>	U -.001	AA	AB	AC	AF	AG	AH	AJ	AK -.005	BB MIN	BC	BD MAX
IN	38.75	20.38	2.875	3.00	16.97	12.69	3.38	31.75	7.00	11.000	12.500	.25	.25	14.00
MM	984	518	73.03		431	322	86	806	178	279.40	317.50	6	6	356

UNITS	BF <sup>4</sup>	BV	ES MIN	XO	SQ KEY
IN	5/8-11 X .94	18.13	5.65	23.38	.750
MM		461	144	594	19.05

1. ALL ROUGH DIMENSIONS MAY VARY BY .25" DUE TO CASTING AND/OR FABRICATION VARIATIONS.
2. LARGEST MOTOR WIDTH.
3. CONDUIT OPENINGS MAY BE LOCATED IN STEPS OF 90 DEGREES REGARDLESS OF LOCATION. STANDARD AS SHOWN WITH CONDUIT OPENING DOWN.
4. TAP SIZE AND BOLT PENETRATION ALLOWANCE.
5. ALL TAPPED HOLES ARE UNIFIED NATIONAL COARSE, RIGHT HAND THREAD.
6. TOLERANCES SHOWN ARE IN INCHES ONLY.

TOLERANCES	
FACE RUNOUT	.007 T.I.R.
PERMISSIBLE ECCENTRICITY OF MOUNTING RABBET	.007 T.I.R.
PERMISSIBLE SHAFT RUNOUT	.003 T.I.R.

09-2330/A

**Nidec Motor Corporation**  
St. Louis, Missouri

INFORMATION DISCLOSED ON THIS DOCUMENT IS CONSIDERED PROPRIETARY AND SHALL NOT BE REPRODUCED OR DISCLOSED WITHOUT WRITTEN CONSENT OF NIDEC MOTOR CORPORATION



ISSUED BY  
**R. KING**  
APPROVED BY  
**J. FARRIS**

IHP\_DP\_NMCA (MAR-2011) SOLIDEDGE