

EFFECTIVE:
11-JUL-14

SUPERSEDES:
06-APR-11

DIMENSION PRINT
EXPLOSION PROOF
FRAME: 320VP, VPH
BASIC TYPE: LV, NV

PRINT:
09-2402

SHEET:
1 OF 1

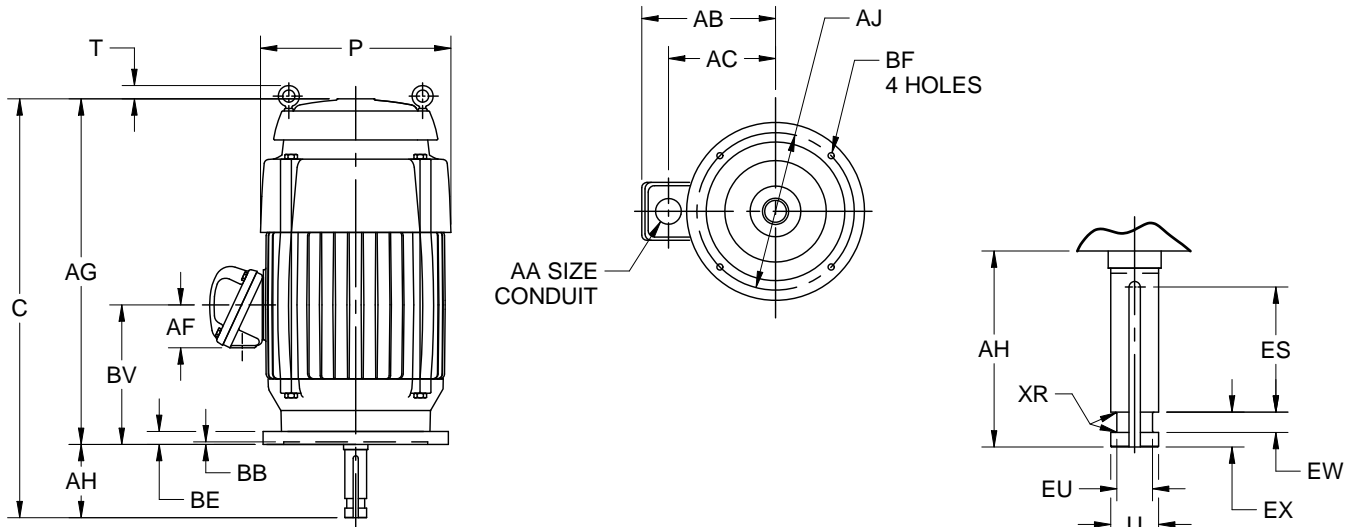

ALL DIMENSIONS ARE IN INCHES AND MILLIMETERS

UNITS	C	P ²	T	U -.001	AA	AB	AC	AF	AG	AH ±.063	BE	BV
IN	34.69	17.00	.88	1.625	2 NPT	15.88	11.25	3.88	30.19	4.500	1.00	11.94
MM	881	432	22	41.28		403	286	99	767	114.30	25	303

UNITS	ES MIN	EU -.005	EW +.002	EX -.005	SQ KEY	XR
IN	3.03	1.250	.375	.750	.375	.03
MM	77	31.75	9.53	19.05	9.53	1

FRAME	UNITS	AJ	AK	BB MIN	BD MAX	BF
324,326VP	IN	14.750	13.500	.25	16.50	.69
	MM	374.65	342.90	6	419	18
324,326VPH	IN	9.125	8.250	.19	12.00	.44
	MM	231.78	209.55	5	305	11

1. ALL ROUGH CASTING DIMENSIONS MAY VARY BY .25" DUE TO CASTING AND/OR FABRICATION VARIATIONS.
2. LARGEST MOTOR WIDTH.
3. CONDUIT OPENING MAY BE LOCATED IN STEPS OF 90° STANDARD AS SHOWN WITH CONDUIT OPENING DOWN.
4. TOLERANCES SHOWN ARE IN INCHES.

TOLERANCES	8.250 AK	13.500 AK
FACE RUNOUT	.004 T.I.R.	.007 T.I.R.
PERMISSIBLE ECCENTRICITY OF MOUNTING RABBET	.004 T.I.R.	.007 T.I.R.
PERMISSIBLE SHAFT RUNOUT	.002 T.I.R.	.002 T.I.R.
"AK" DIMENSION	+ .003; - .000	+ .005; - .000
FOR IEEE841 SPECIAL RUNOUT	.001 T.I.R.	.001 T.I.R.

09-2402/B

Nidec Motor Corporation
St. Louis, Missouri

INFORMATION DISCLOSED ON THIS DOCUMENT IS CONSIDERED PROPRIETARY AND SHALL NOT BE REPRODUCED OR DISCLOSED WITHOUT WRITTEN CONSENT OF NIDEC MOTOR CORPORATION



ISSUED BY
M. YRISSON
APPROVED BY
F. LARA

IHP_DP_NMCA (MAR-2011) SOLIDEDGE