

EFFECTIVE:
26-MAY-16

SUPERSEDES:
NEW

DIMENSION PRINT
W/OVERSIZED C.I. O/B (SIZE #2)
FRAME: 400TP, TPA
BASIC TYPE: RU, RUE, RUI, RUS

PRINT:
09-3252

SHEET:
1 OF 1

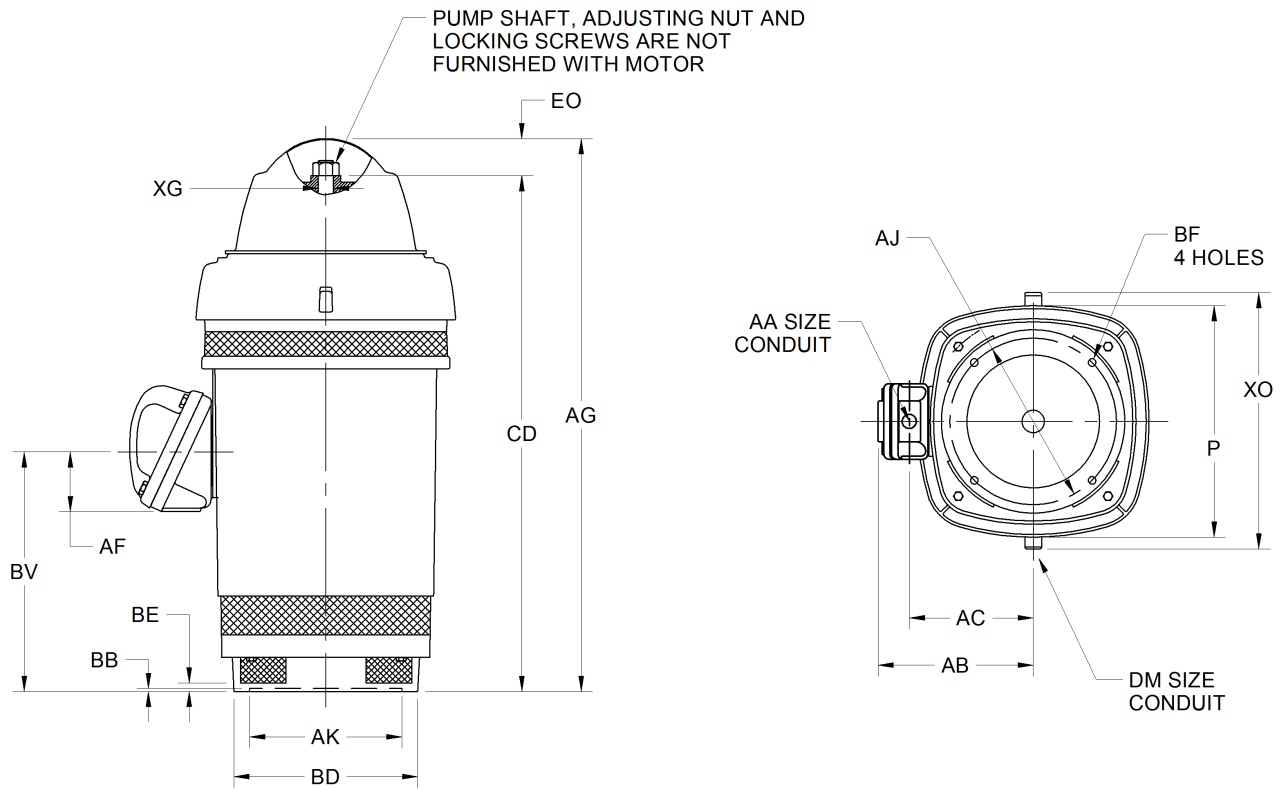

ALL DIMENSIONS ARE IN INCHES AND MILLIMETERS

| UNITS | P ² | AA | AB | AC | AF | AG | AJ | AK +.005 | BB MIN | BE | BF | BV |
|-------|----------------|-----------|-------|-------|------|-------|--------|-------------|-----------|-----|-----|-------|
| IN | 23.25 | 3-1/2 NPT | 19.50 | 14.88 | 8.06 | 42.69 | 14.750 | 13.500 | .25 | .75 | .69 | 18.13 |
| MM | 591 | | 495 | 378 | 205 | 1084 | 374.65 | 342.90 | 6 | 19 | 18 | 461 |

| UNITS | CD | EO | XG | XO |
|-------|-------|------|------|-------|
| IN | 36.94 | 5.50 | 1.88 | 21.13 |
| MM | 938 | 140 | 48 | 537 |

| FRAME | UNITS | BD MAX |
|--------|-------|-----------|
| 400TP | IN | 16.50 |
| | MM | 419 |
| 400TPA | IN | 20.00 |
| | MM | 508 |

| TOLERANCES | |
|---|-------------|
| FACE RUNOUT | .007 T.I.R. |
| PERMISSIBLE ECCENTRICITY OF MOUNTING RABBET | .007 T.I.R. |
| PERMISSIBLE SHAFT RUNOUT | .003 T.I.R. |

1. ALL ROUGH DIMENSIONS MAY VARY BY .25" DUE TO CASTING AND/OR FABRICATION VARIATIONS.
2. LARGEST MOTOR WIDTH.

3. CONDUIT BOX MAY BE LOCATED ON EITHER SIDE OF MOTOR. CONDUIT OPENINGS MAY BE LOCATED IN STEPS OF 90 DEGREES REGARDLESS OF LOCATION. STANDARD AS SHOWN WITH CONDUIT OPENING DOWN.

Nidec Motor Corporation
St. Louis, Missouri

INFORMATION DISCLOSED ON THIS DOCUMENT IS CONSIDERED PROPRIETARY AND SHALL NOT BE REPRODUCED OR DISCLOSED WITHOUT WRITTEN CONSENT OF NIDEC MOTOR CORPORATION



ISSUED BY
F. CRUZ
APPROVED BY
B. LANDGRAF

IHP_DP_NMCA (MAR-2011) SOLIDEDGE