

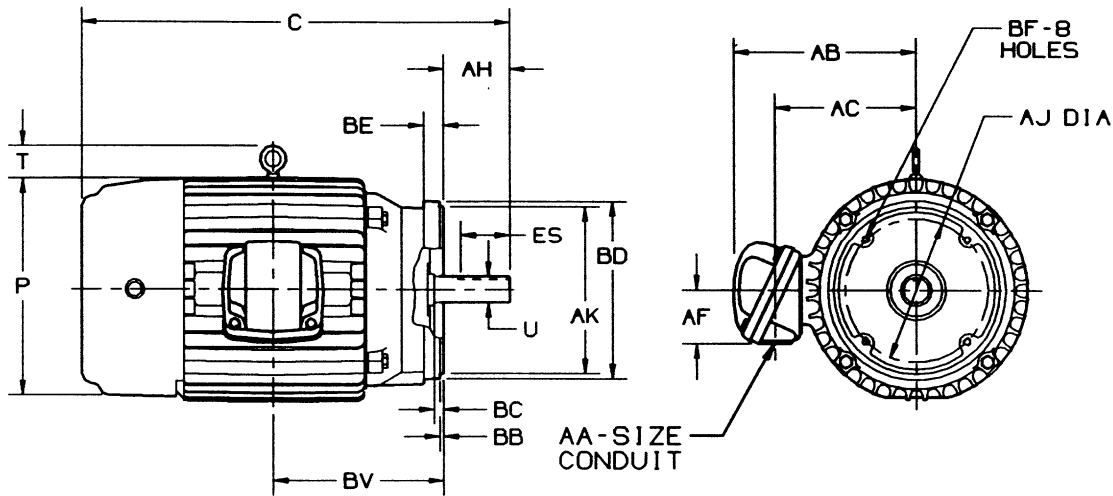

HORIZONTAL MOTOR

NEMA "C" BRACKET
 FRAME: 213,215C
 TYPE: EADF

REFERENCE: 1022-1-73
 EFFECTIVE: 04-AUG-94
 SUPERSEDES: NEW



ALL DIMENSIONS ARE IN INCHES

FRAME	C	P	T	U	AA	AB	AC	AF	AH	AJ
213,215C	19-9/16	11-1/8	2	1-1/8	1	9-1/16	6-13/16	2-5/8	2-3/4	7-1/4

FRAME	AK	BB	BC	BD	BE	BF	BV	ES	SQ.
	-.003	MIN.				6		MIN.	KEY
213,215C	8-1/2	1/4	5/16	9	-	1/2-13 X 3/4	8	2-3/8	5/16

TOLERANCES	
FACE RUNOUT	.006 F.I.R.
PERMISSIBLE ECCENTRICITY OF MOUNTING RABBET	.006 F.I.R.
PERMISSIBLE SHAFT RUNOUT	.003 F.I.R.

- 1) ALL ROUGH CASTING DIMENSIONS MAY VARY BY 1/4" DUE TO CASTING VARIATIONS.
- 2) SHAFT EXTENSION DIAMETER TOLERANCE: +.0000/- .0005 UP TO 1-1/2 INCLUSIVE. LARGER DIAMETERS: +.000/- .001.
- 3) ALL TAPPED HOLES ARE UNIFIED NATIONAL COARSE, RIGHT HAND THREAD.
- 4) CONDUIT BOX CAN BE LOCATED ON EITHER SIDE AND OPENING MAY BE LOCATED IN STEPS OF 90 DEGREES REGARDLESS OF LOCATION. STANDARD AS SHOWN WITH CONDUIT OPENING DOWN.
- 5) LARGEST MOTOR WIDTH.
- 6) TAP SIZE AND BOLT PENETRATION ALLOWANCE.

CERTIFIED BY: _____ DATE: _____



U.S. ELECTRICAL MOTORS
 DIVISION OF EMERSON ELECTRIC CO.



DO NOT USE FOR CONSTRUCTION
 PURPOSES UNLESS CERTIFIED