

EFFECTIVE:
02-AUG-16

DIMENSION PRINT
WEATHER PROTECTED TYPE I
FRAME: 284HP THRU 286HPH
BASIC TYPE: AV

PRINT:
1200-5-65

SUPERSEDES:
NEW

SHEET:
1 OF 1

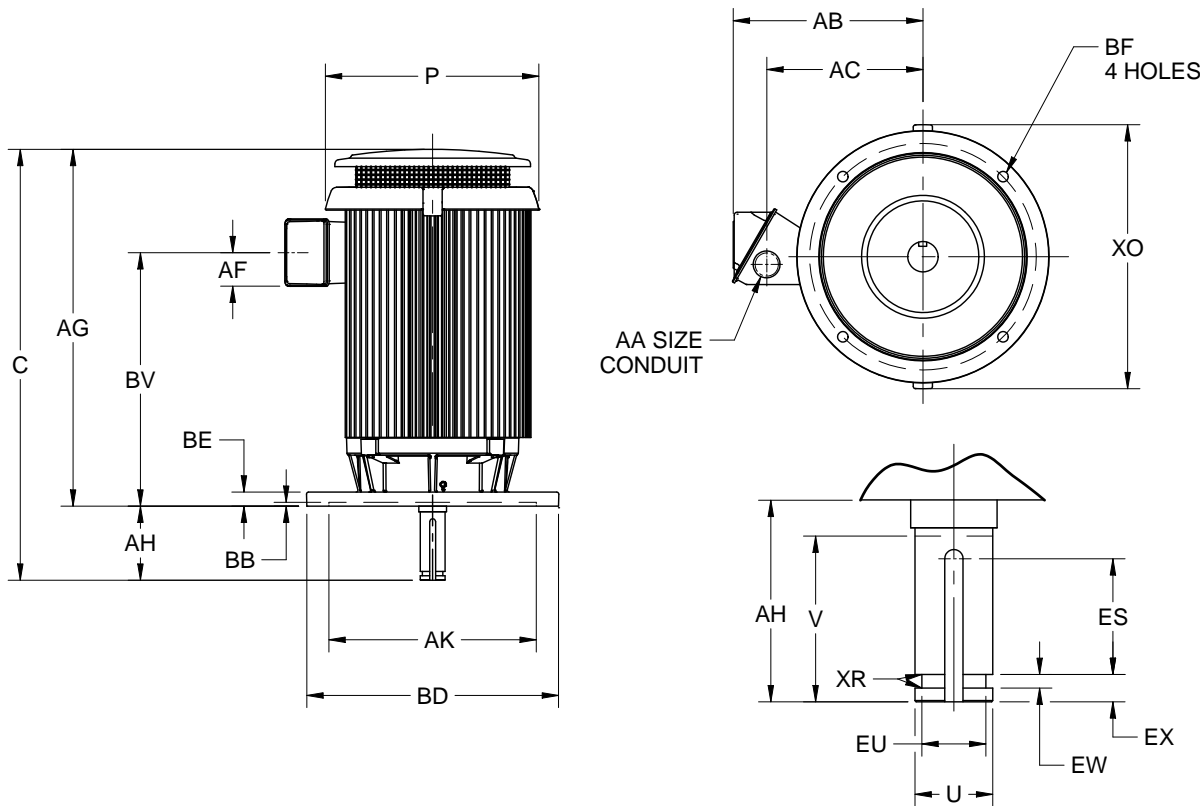

ALL DIMENSIONS ARE IN INCHES AND MILLIMETERS

UNITS	P ²	AA	AB	AC	AF	AG	BE	BV	EW +.002	EX -.005	XO	XR
IN	14.00	1.50	11.07	8.32	2.59	22.60	1.00	16.50	.375	.750	16.88	.03
MM	356		281	211	66	274	25	419	9.53	19.05	429	1

FRAME	UNITS	C	U -.001	V MIN	AH ±.062	AJ	AK	BB MIN	BD MAX	BF	ES MIN	EU -.005
284, 286HP	IN	25.35	1.125	2.75	2.750	9.125	8.250	.19	10.00	.44	1.31	.875
	MM	644	28.58	70	69.85	231.78	209.55	5	254	11	33	22.23
284, 286HPH	IN	27.10	1.625	4.50	4.500	14.750	13.500	.25	16.50	.69	3.06	1.250
	MM	688	41.28	114	114.30	374.65	342.90	6	419	18	78	31.75

FRAME	UNITS	SQ KEY
284, 286HP	IN	.250
	MM	6.35
284, 286HPH	IN	.375
	MM	9.53

- ALL ROUGH DIMENSIONS MAY VARY BY .25" DUE TO CASTING AND/OR FABRICATION VARIATIONS.
- LARGEST MOTOR WIDTH.
- CONDUIT OPENINGS MAY BE LOCATED IN STEPS OF 180°. STANDARD AS SHOWN WITH CONDUIT OPENING DOWN.
- TOLERANCES SHOWN ARE IN INCHES ONLY.
- SHAFT EXTENSION DIAMETER TOLERANCE: +.0000;-.0005 UP TO 1-1/2" INCLUSIVE.
LARGE DIMETERS: +.000;-.001
- FRAME REFERENCE 14.750" / 284 / 286.

TOLERANCES	8.250 AK	13.500 AK
FACE RUNOUT	.004 T.I.R.	.006 T.I.R.
PERMISSIBLE ECCENTRICITY OF MOUNTING RABBET	.004 T.I.R.	.006 T.I.R.
PERMISSIBLE SHAFT RUNOUT	.002 T.I.R.	.002 T.I.R.
TOLERANCE ON AK-DIMENSION	+.004	+.006
SPECIAL SHAFT RUNOUT	.001 T.I.R.	.001 T.I.R.

Nidec Motor Corporation
St. Louis, Missouri

INFORMATION DISCLOSED ON THIS DOCUMENT IS CONSIDERED PROPRIETARY AND SHALL NOT BE REPRODUCED OR DISCLOSED WITHOUT WRITTEN CONSENT OF NIDEC MOTOR CORPORATION



ISSUED BY
R. MARTINEZ
APPROVED BY
K. VALADEZ

IHP_DP_NMCA (MAR-2011) SOLIDEDGE