

#12 GREEN GROUND LEAD
TO BE 12" BETWEEN
CENTERS OF TERMS.
TERM. TO FIT #10 SCREW

NAMEPLATE

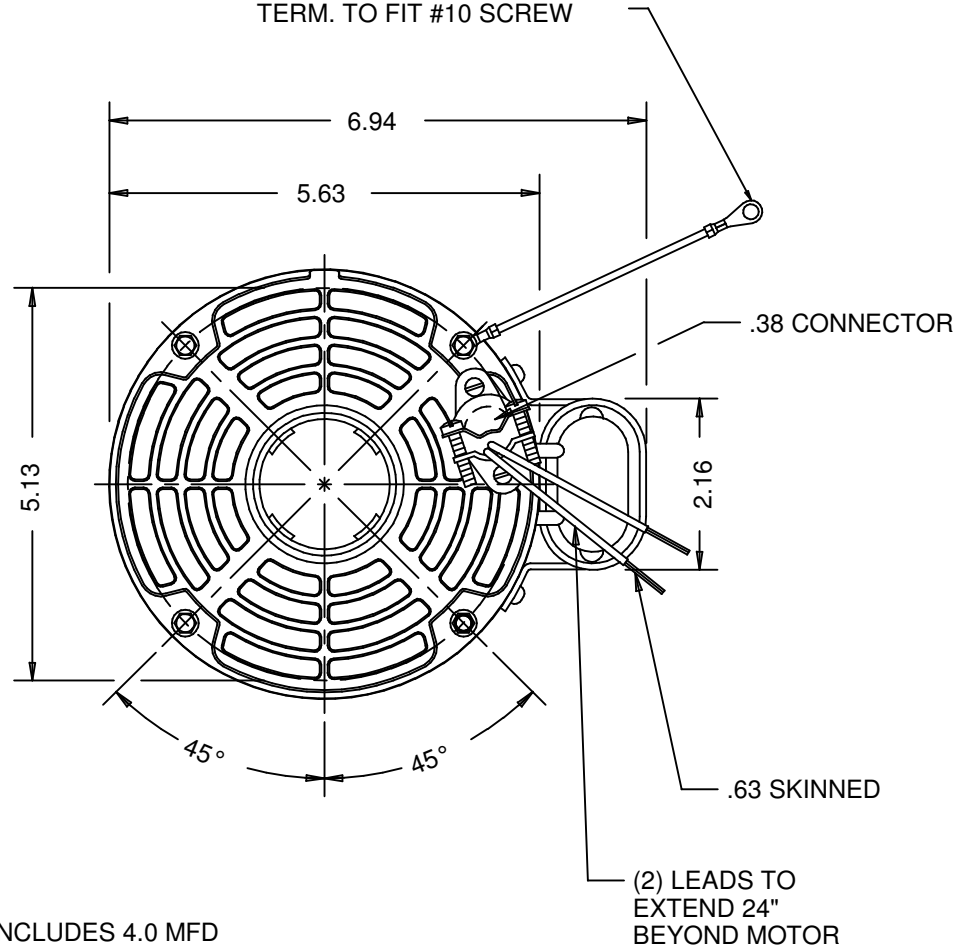

INCLUDES 4.0 MFD
370-VAC CAPACITOR

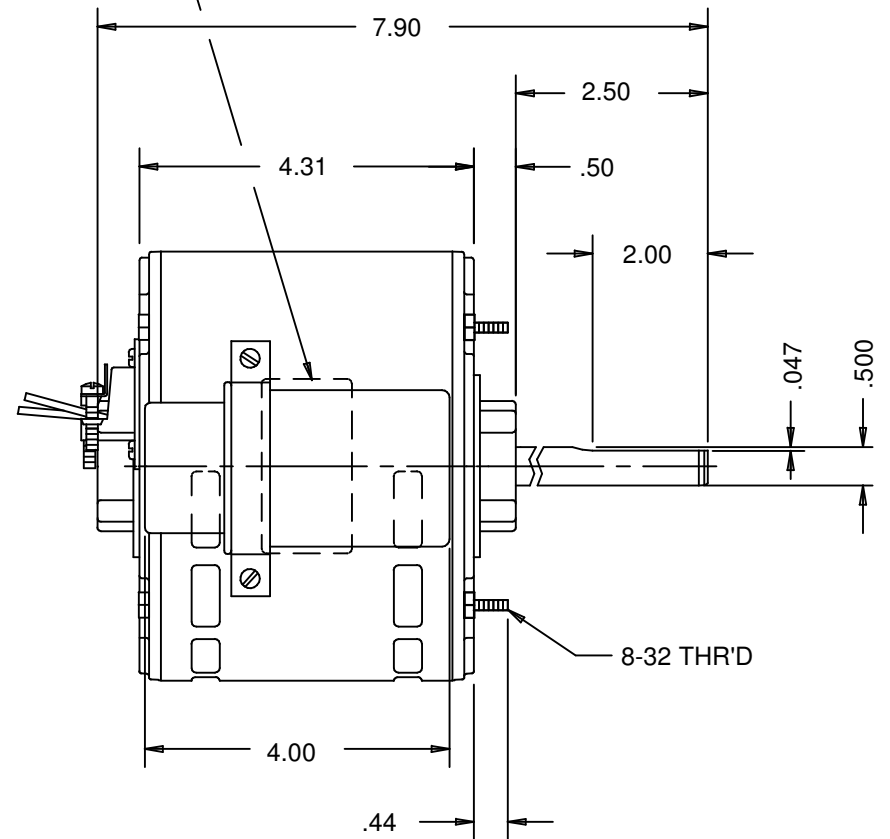

NIDEC MOTOR CORPORATION 12-Oct-12

MODEL		REF	CUSTOMER	HP	VOLTS	AMPS	HZ	RPM	ROTATION	CUSTOMER PN	
K55HXSMD-1648		--	STANDARD	1/5	208-230	2.0	60	1075	CCW LEAD END	1648	
SHEET NUMBER 1 OF 1	REV C	REVISION RECORD FOR: C6404-00			INFORMATION DISCLOSED ON THIS DOCUMENT IS CONSIDERED PROPRIETARY AND SHALL NOT BE REPRODUCED OR DISCLOSED WITHOUT WRITTEN CONSENT OF NIDEC MOTOR CORPORATION				NIDEC MOTOR CORPORATION		
		UPDATED ENGINEER APPROVED TO B. GAITAN									
REVISION DATE											
12-OCT-12											
					ALL DIMENSIONS ARE FOR REFERENCE ONLY UNLESS TOLERANCE IS GIVEN						
ISSUED BY R. MORALES		REVIEWED BY M. LARGENT		ENGINEER APPROVED B. GAITAN	TITLE ASSEMBLED VIEW				CODE V01	ITEM NO. 252729	SIZE A
				REV C							

ALL DIMENSIONS ARE FOR REFERENCE ONLY UNLESS TOLERANCE IS GIVEN