

MODEL	REF	CUSTOMER	HP	VOLTS	AMPS	HZ	RPM	ROTATION	CATALOG #	DESCRIPTION / REMARKS
K55HRJP-2173	C41106-3	WHOLESALE HAC	1/4	115	4.1	60	1625/3 SPD	CCW LE	NAL1024	

KIT WITH BRACKET ASSEMBLY, RINGS  
SCREWS AND NUTS TO BE INCLUDED  
IN CARTON BOX.

AUTOMATIC THERMAL  
PROTECTOR

SEAM WELD  
LACATION

(2) .250 FLAG  
TYPE Q.C TERMS

#16 GREEN/YELLOW GROUND LEAD  
TO BE 24.0±1 BETWEEN CENTERS  
OF TERMINALS, TERMINAL TO FIT  
#10 SCREW

6 LEADS #18, 0.031 THICK INSUL.  
TO EXTEND BEYOND MOTOR:  
WHT=36.0±1, BLUE=36.0±1  
BLK=36.0±1, RED=36.0±1  
BRN=36.0±1, BRN/WHT STRIPE 36.0 ±1  
LEADS TO BE PROTECTED WITH GROMMET.

(4) #8-32  
THR'D

0.625 ±0.062  
SKINNED

NAMEPLATE

SPRING WASHER

GROOVE FOR  
IDENT ONLY

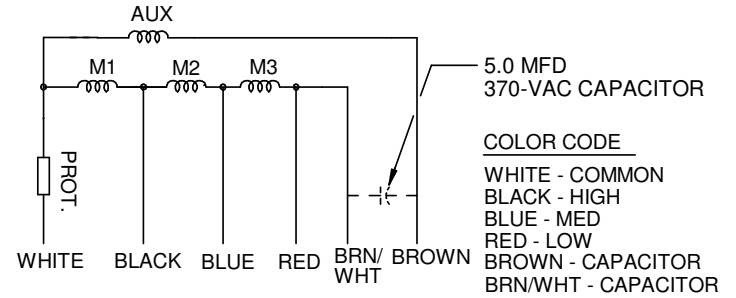
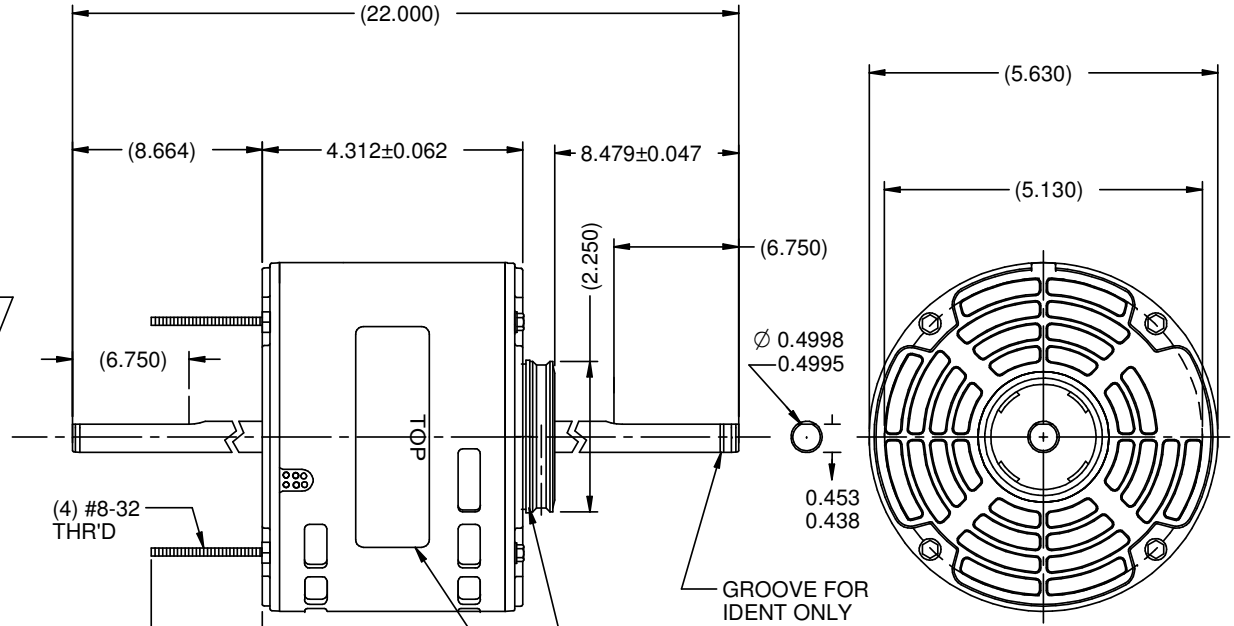

NIDEC MOTOR CORPORATION 24-Feb-16

REFER TO S.E.I.M. 24-1

REVISION RECORD FOR:	ECO-E25005
DELETED NOTE "FIGURES TO BE PRINTED ON LEADS"	
ISSUED BY:	C.ALMAGUER
ENGINEER APPROVED:	A.LOZANO

TOLERANCES ON DIMENSIONS  
(UNLESS OTHERWISE SPECIFIED)

INCHES  
.XX = ± .010  
.XXX = ± .005

mm

ANGLES X° = ±1°

**NIDEC MOTOR CORPORATION**

INFORMATION DISCLOSED ON THIS DOCUMENT IS CONSIDERED PROPRIETARY AND SHALL NOT BE  
REPRODUCED OR DISCLOSED WITHOUT WRITTEN CONSENT OF NIDEC MOTOR CORPORATION

REVISION DATE:  
24-FEB-16

TITLE	CODE	ITEM NO.	REV	SHEET NUMBER	DWG SIZE
CUSTOMER DETAIL DRAWING	V02	808741	A	1 OF 3	B