

EFFECTIVE:
08-FEB-11

HORIZONTAL MOTORS

PRINT:
07-2821

SUPERSEDES:
23-MAR-10

WITH NEMA "C" BRACKET

SHEET:
1 OF 1

FRAME: 400TC, TSC
BASIC TYPE: CT

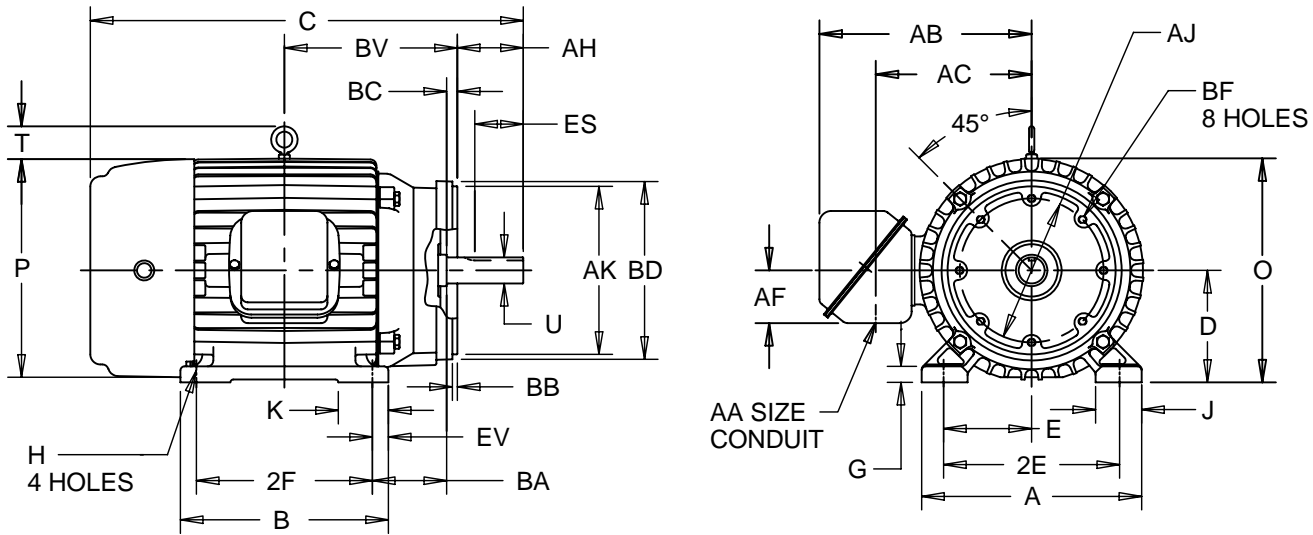

ALL DIMENSIONS ARE IN INCHES AND MILLIMETERS

UNITS	A	B	D -.06	E	2E ±.03	G	H +.05	J	K	O	P ⁵
IN	19.75	16.75	10.00	8.00	16.00	1.38	.81	3.75	5.00	20.50	20.88
MM	502	426	254	203	406	35	21	95	127	521	530

UNITS	T	AA	AB	AC	AF	AJ	AK -.005	BA	BB MIN	BC	BD MAX
IN	2.94	3.00	18.42	14.13	4.72	11.000	12.500	6.63	.25	.25	15.50
MM	75		468	359	120	279.40	317.50	168	6	6	394

UNITS	BF ²	BV	EV
IN	5/8-11X .94	13.75	1.50
MM		349	38

FRAME	UNITS	C	U -.001	AH	ES MIN	SQ KEY
400TC	IN	39.88	2.875	7.00	5.65	.750
	MM	1013	73.03	178	144	19.05
400TSC	IN	36.88	2.125	4.00	2.78	.500
	MM	937	53.98	102	71	12.70

FRAME	UNITS	2F ±.03
404TC, TSC	IN	12.25
	MM	311
405TC, TSC	IN	13.75
	MM	349

- 1: ALL ROUGH DIMENSIONS MAY VARY BY .25" DUE TO CASTING AND/OR FABRICATION VARIATIONS.
- 2: TAP SIZE AND BOLT PENETRATION ALLOWANCE.
- 3: ALL TAPPED HOLES ARE UNIFIED NATIONAL COARSE, RIGHT HAND THREAD.
- 4: CONDUIT BOX MAY BE LOCATED ON EITHER SIDE OF MOTOR. CONDUIT OPENINGS MAY BE LOCATED IN STEPS OF 90 DEGREES REGARDLESS OF LOCATION. STANDARD AS SHOWN WITH CONDUIT OPENING DOWN.
- 5: LARGEST MOTOR WIDTH.
- 6: TOLERANCES SHOWN ARE IN INCHES ONLY.

TOLERANCES	
FACE RUNOUT	.007 T.I.R.
PERMISSIBLE ECCENTRICITY OF MOUNTING RABBET	.007 T.I.R.
PERMISSIBLE SHAFT RUNOUT	.003 T.I.R.



ISSUED BY
R. KING
APPROVED BY
J. O'BRIEN