

EFFECTIVE:
01-MAR-12

SUPERSEDES:
28-NOV-11

HORIZONTAL MOTORS

OPEN

FRAME: 56J
BASIC TYPE: D

PRINT:
07-2981

SHEET:
1 OF 1

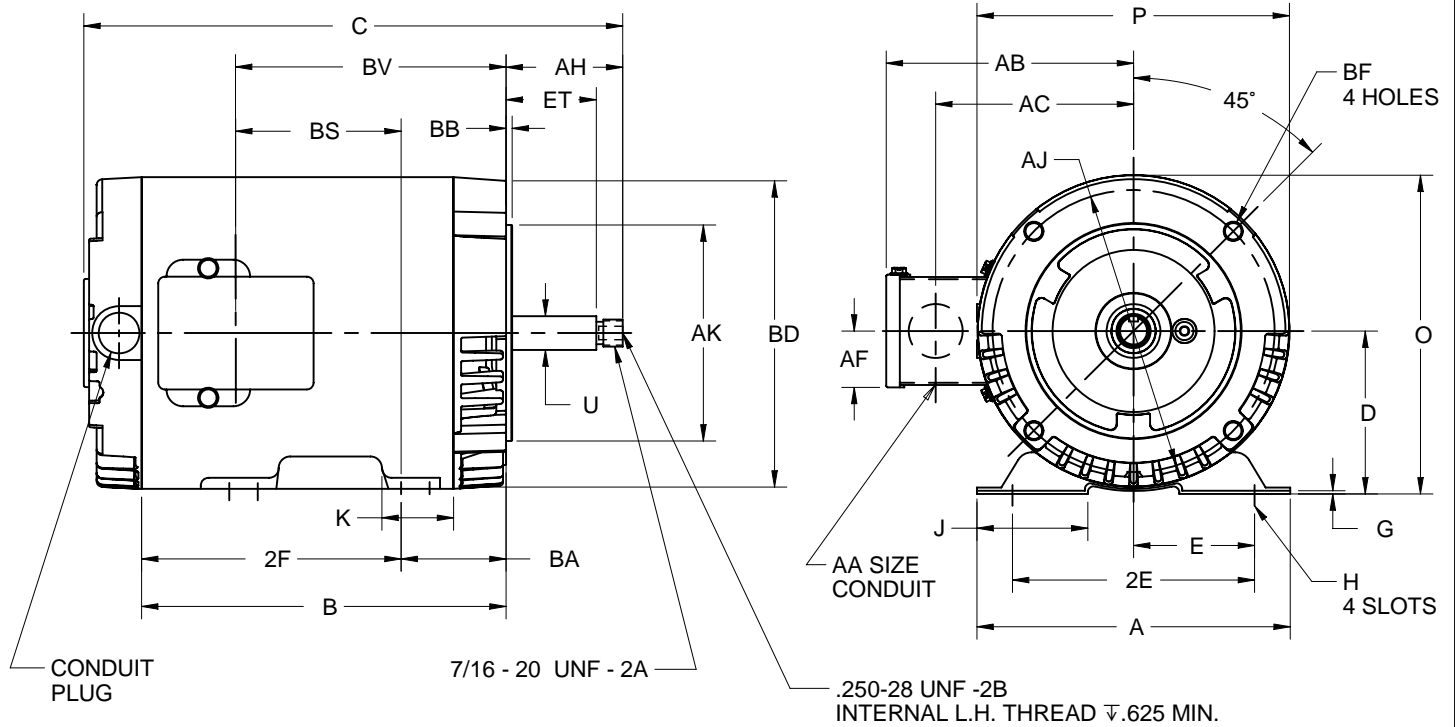

ALL DIMENSIONS ARE IN INCHES AND MILLIMETERS

UNITS	A	B	C	D -.03	E	2E	2F	G	H	J	K	O
IN	6.50	6.50	14.86	3.50	2.44	4.875	5.00	.104	.344 X 1.25	1.66	1.38	6.75
MM	165	165	377	89	62	123.82	127	2.64		42	35	171

UNITS	P ²	U -.0005	AA	AB	AC	AF	AH	AJ	AK -.003	BA	BB MIN	BD MAX
IN	6.50	.6250	.88 NPT	5.44	4.13	1.13	2.56	5.875	4.500	2.56	.13	6.50
MM	165	15.875		138	105	29	65	149.23	114.30	65	3	165

UNITS	BF ⁴	BS	BV	ET ±.015
IN	.375-16 x .75	4.94	8.66	1.875
MM		125	220	47.62

- ALL ROUGH CASTING DIMENSIONS MAY VARY BY .25" DUE TO CASTING AND/OR FABRICATION VARIATIONS.
- LARGEST MOTOR WIDTH.
- TAP SIZE AND BOLT PENETRATION ALLOWANCE.

- ALL TAPPED HOLES ARE UNIFIED NATIONAL COARSE, RIGHT HAND THREAD.
- CONDUIT HOLE KNOCKOUTS AVAILABLE ON ALL 4 SIDES OF CONDUIT BOX.
- TOLERANCES SHOWN ARE IN INCHES ONLY.
- FRAME REFERENCE: 10.000/56

TOLERANCES	
FACE RUNOUT	.004 T.I.R.
PERMISSIBLE ECCENTRICITY OF MOUNTING RABBET	.004 T.I.R.
PERMISSIBLE SHAFT RUNOUT	.002 T.I.R.

Nidec Motor Corporation
St. Louis, Missouri

INFORMATION DISCLOSED ON THIS DOCUMENT IS CONSIDERED PROPRIETARY AND SHALL NOT BE REPRODUCED OR DISCLOSED WITHOUT WRITTEN CONSENT OF NIDEC MOTOR CORPORATION



ISSUED BY
R. KING
APPROVED BY
J. HAGENE